

Dairyfields, Crawley, RH11 8EW

Asking Price £335,000

Council Tax Band: C



LOCATION

We are delighted to bring to the market this spacious, three bedroom property in a quiet cul-de sac, in the popular neighbourhood of Gossops Green. Located in a highly convenient location, less than a 10 minute walk to Ifield Station, a primary school, pre-school and a parade of shops with takeaway outlets, a post office, pharmacy and convenience store. It is also just under two miles to the centre of Crawley with its wealth of cafes and shops.



Open House Horsham

Ground Floor

Approx. 41.0 sq. metres (441.7 sq. feet)

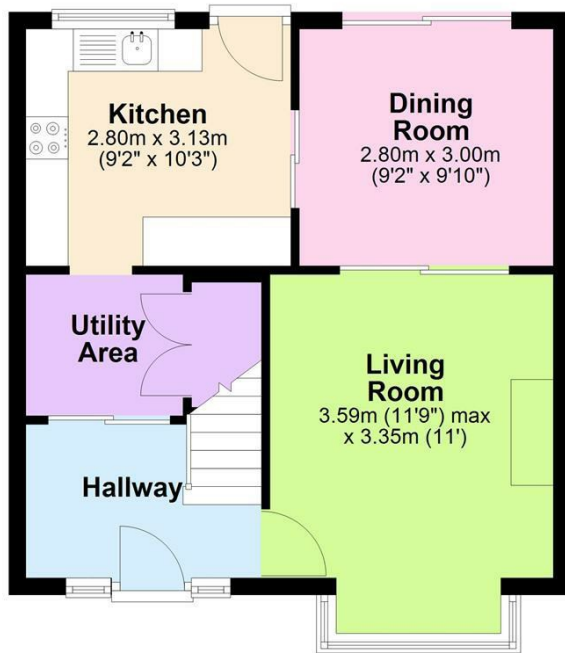

First Floor

Approx. 40.4 sq. metres (434.3 sq. feet)

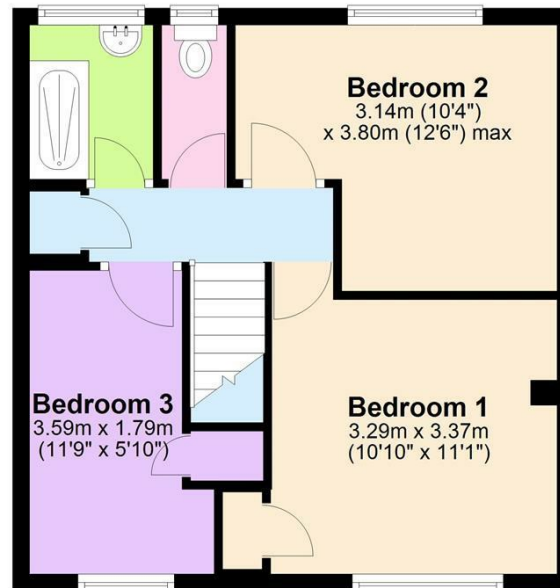

Total area: approx. 81.4 sq. metres (876.0 sq. feet)

Dairyfields



Energy Efficiency Rating		Current	Potential
Very energy efficient - lower running costs			
(92 plus)	A		
(81-91)	B		
(69-80)	C		
(55-68)	D		
(39-54)	E		
(21-38)	F		
(1-20)	G		
Not energy efficient - higher running costs			
		62	79
England & Wales		EU Directive 2002/91/EC	