



Bethnal Green Road, E2

£2,000 Per calendar month

The property comprises of two well-proportioned bedrooms. The apartment is offered fully furnished, making it an ideal option for professionals or sharers looking for a move-in-ready home.

Positioned within easy reach of Bethnal Green's excellent local amenities, residents will enjoy a wide selection of cafés, restaurants, shops and markets nearby. The property also benefits from superb transport links, providing quick and convenient access into Shoreditch, the City and central London.

Features

- Two Bedroom
- One Bathroom
- Separate Living Space
- Furnished
- Great Location
- 615 sq ft

Bethnal Green Road, London, E2

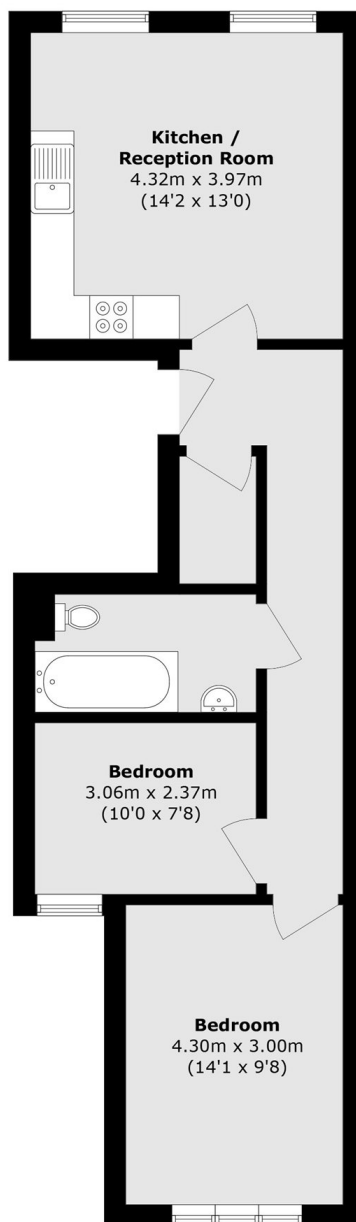

Total area (approx.): 56.9 sq. m (612.5 sq. ft)