



Long Breech

Mawsley, Northamptonshire

oriordanbond
SALES & LETTINGS



Long Breech

Mawsley
NN14 1TR

PRICE £235,000

A modern three bedroom town house, with an allocated off road parking space, in this desirable modern village. Mawsley offers a wide range of local facilities including shops schools pub doctors dentist and recreational facilities. The property has been refurbished internally and is well presented throughout.

The accommodation over three floors includes entrance hall, cloakroom/WC, fitted kitchen, sitting/dining room, first floor landing, two double bedrooms, re-fitted bathroom/WC, second floor landing and a spacious third double bedroom. Outside, there is a front garden with an allocated parking space directly opposite and the rear garden is fully enclosed and private. Further benefits include gas radiator heating and uPVC double glazing. (A/749/S)

Additional information

- Council Tax Band: B
- Energy Efficiency Rating: C

Viewing

Viewing strictly by appointment – details below

Disclaimer

O’Riordan Bond Estate Agents Limited has not tested apparatus, equipment, fittings or services and so cannot verify they are in working order. The buyer is advised to obtain verification from their solicitor or surveyor.

O’Riordan Bond Brixworth Sales
01604 880077

brixworth@oriordanbond.co.uk



GROUND FLOOR
306 sq.ft. (28.4 sq.m.) approx.

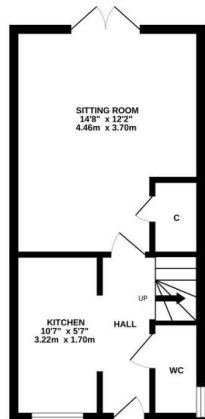

1ST FLOOR
289 sq.ft. (26.9 sq.m.) approx.



2ND FLOOR
154 sq.ft. (14.3 sq.m.) approx.

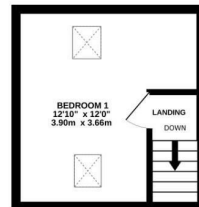

TOTAL FLOOR AREA: 749 sq.ft. (69.6 sq.m.) approx.
Whilst every attempt has been made to ensure the accuracy of the floorplan contained here, measurements of doors, windows, rooms and any other items are approximate and no responsibility is taken for any error, omission or mis-statement. This plan is for illustrative purposes only and should be used as such by any prospective purchaser. The services, systems and appliances shown have not been tested and no guarantee as to their condition or efficiency can be given.
Made with Metropac C2028