

New Retort House

HARBOURSIDE

APPROXIMATE FLOOR AREA
77 SQM / 828 SQFT

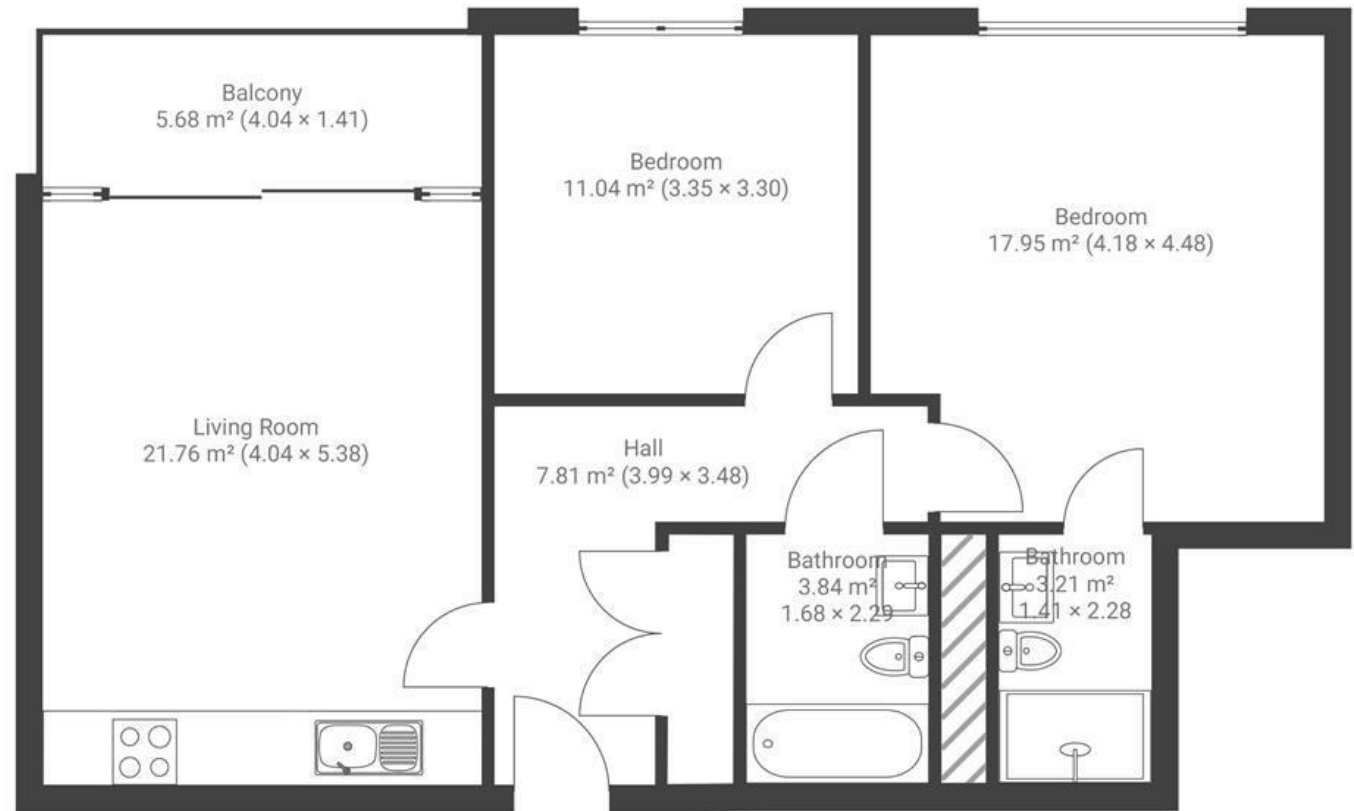

Boardwalk

Lime Kiln Road

, BRISTOL

£

£485,000

z^z

2 Bedrooms



BS1 5DZ



2 Bathrooms

"Living in New Retort House has been really easy. The location is so convenient to get into town or spend sunny afternoons around the harbourside. The building itself is well managed and always really friendly."

