



KHARTOUM ROAD, SW17

£425,000

Victorian Maisonette
West facing garden
Home office
Ground floor
Close to Tooting Broadway
Great condition

@marshandparsons
marshandparsons.co.uk

MARSH &
PARSONS

ABOUT THE PROPERTY

Offers in excess of A beautifully presented ground floor maisonette with a spacious private garden, a home office, and only a short walk from Tooting Broadway tube station.

The property is located on a quiet residential street just a short walk from the vibrant Tooting High Street and all its local amenities. The property boasts excellent transport connections via Tooting Broadway (Northern Line, Zone 3), Tooting and Earlsfield Rail Stations, as well as host of buses. The property is within walking distance of the open spaces of Springfield Park and Tooting Common.









STEP INSIDE KHARTOUM ROAD

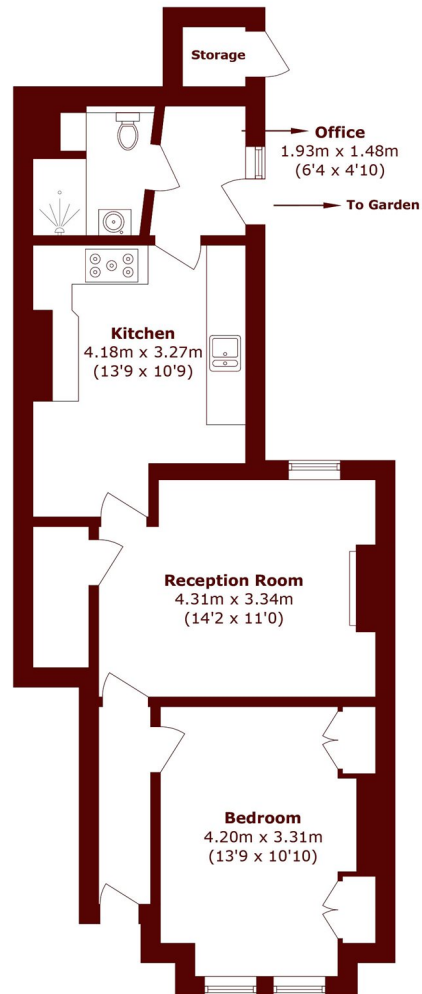

Total area (approx.): 52.6 sq. m (566.1 sq. ft)
External storage area (approx.): 0.8 sq. m (8.6 sq. ft)

Tooting
020 8767 3655

Energy Rating: D We aim to make our particulars both accurate and reliable. However, they are not guaranteed; nor do they form part of an offer or contract. If you require clarification on any points then please contact us, especially if you're traveling some distance to view. Please note that appliances and heating systems have not been tested and therefore no warranties can be given as to their good working order

**MARSH &
PARSONS**