



## CLAPHAM COMMON NORTH SIDE, £895,000

Grade II Listed Gated Building  
Two Double Bedrooms  
Communal Gardens  
Views over Clapham Common  
Lease of 139 years remaining  
Energy Rating: C

@marshandparsons  
marshandparsons.co.uk

MARSH &  
PARSONS

# ABOUT THE PROPERTY

A beautiful two bedroom apartment on the second floor of a well maintained Grade II listed building with direct views over Clapham Common. The property benefits from gated communal gardens and is sold chain free.

This stunning property boasts generous lateral living space, including a beautiful reception room with whitewashed wooden floors, panelled walls, and large windows that create an excellent sense of light and space. The flat also features a contemporary marble bathroom and a modern kitchen with marble worktops, a breakfast bar, and integrated appliances. It further benefits from access to both front and rear communal gardens.









# STEP INSIDE

## CLAPHAM COMMON NORTH SIDE

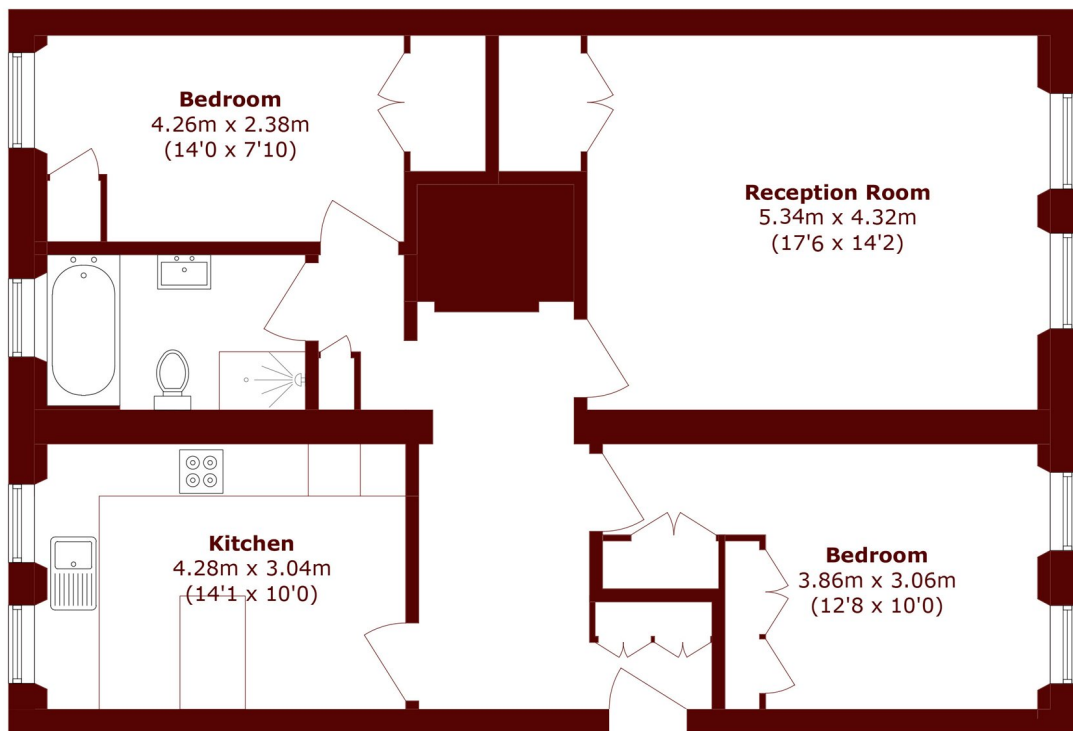

Total area (approx.): 90.9 sq. m (978.4 sq. ft)

**Clapham**  
020 7501 3666

Energy Rating: C We aim to make our particulars both accurate and reliable. However, they are not guaranteed; nor do they form part of an offer or contract. If you require clarification on any points then please contact us, especially if you're traveling some distance to view. Please note that appliances and heating systems have not been tested and therefore no warranties can be given as to their good working order

**MARSH &  
PARSONS**