



Willow Rise, Downswood, Maidstone, Kent, ME15 8XR

Price £160,000



Tucked away in a quiet cul-de-sac in the sought after area of Downwood is this beautifully presented one bedroom apartment. The communal entrance brings you into a well-kept block, with this lovely property situated on the first floor. The internal hallway leads to the bedroom, open-plan living accommodation and bathroom.

The apartment has excellent natural light and has recently been refurbished to provide a modern kitchen and contemporary bathroom. The open-plan kitchen/lounge/diner benefits from a lovely bay window and is presented in excellent decorative order.

This property is perfect for first time buyers and also represents a good buy-to-let investment and is offered with the huge advantage of having no onwards chain.

We encourage your earliest possible viewing. Tenure: Leasehold, 99 years remaining, service charge £2254.44 PA. Council Tax band: A. EPC rating: C.



LOCATION

Positioned on a sought-after road in Downswood, the locality of this property adds to its allure. The area is renowned for its close-knit community, accessible amenities including the parade of shops and Madginford Infant and Junior School, as well as nearby green spaces, making it an ideal setting for families, professionals, and anyone looking to balance peaceful living with convenience. The picturesque village centre of Bearsted is close by where there is a delightful Green, surrounded by historic buildings, sports/leisure clubs, pubs, cafe's, restaurants, parish church and London line station. The beautiful grounds of Mote Park are within walking distance, and there is a frequent bus service to Maidstone town centre.

GROUND FLOOR

Communal Entrance Hall

Stairs to First Floor

FIRST FLOOR

Communal First Floor Landing

Entrance to Apartment

Apartment Hallway

Open-Plan Kitchen/Dining/Sitting Room

Bedroom

Bathroom

EXTERIOR

Bin Store

Bicycle Store

Car Park with allocated parking space

VIEWING

Strictly by arrangement with the Agent's Bearsted Office, 132 Ashford Road, Bearsted, Maidstone, Kent ME14 4LX. Tel: 01622 739574.

Energy Efficiency Rating		
	Current	Potential
<i>Very energy efficient - lower running costs</i>		
(92 plus) A		
(81-91) B		
(69-80) C	77	80
(55-68) D		
(39-54) E		
(21-38) F		
(1-20) G		
<i>Not energy efficient - higher running costs</i>		
England & Wales	EU Directive 2002/91/EC	

Page & Wells limited for themselves and for the vendors of this property whose agents they are give notice that: 1. These particulars do not constitute any part of, an offer or a contract. 2. All statements contained in these particulars as to this property are made without responsibility on the part of Page & Wells Limited or the Vendor. 3. None of the statements contained in these particulars as to the property is to be relied on as statements or representations of fact. 4. Any intending purchaser must satisfy himself by inspection or otherwise as to the correctness of each of the statements contained in these particulars. 5. The vendor does not make or give, and neither Page & Wells Limited nor any person in their employment has any authority to make or give any representation whatsoever in relation to this property. These particulars are supplied on the understanding that all negotiations are carried out throughout Page & Wells Limited. Properties with a reference prefixes EAA are those which Page & Wells Limited disclose an interest in accordance with the provisions of the Estates Agents Act 1979

Willow Rise, Downswood, Maidstone
Approximate Gross Internal Area
462 Sq Ft/43 Sq M

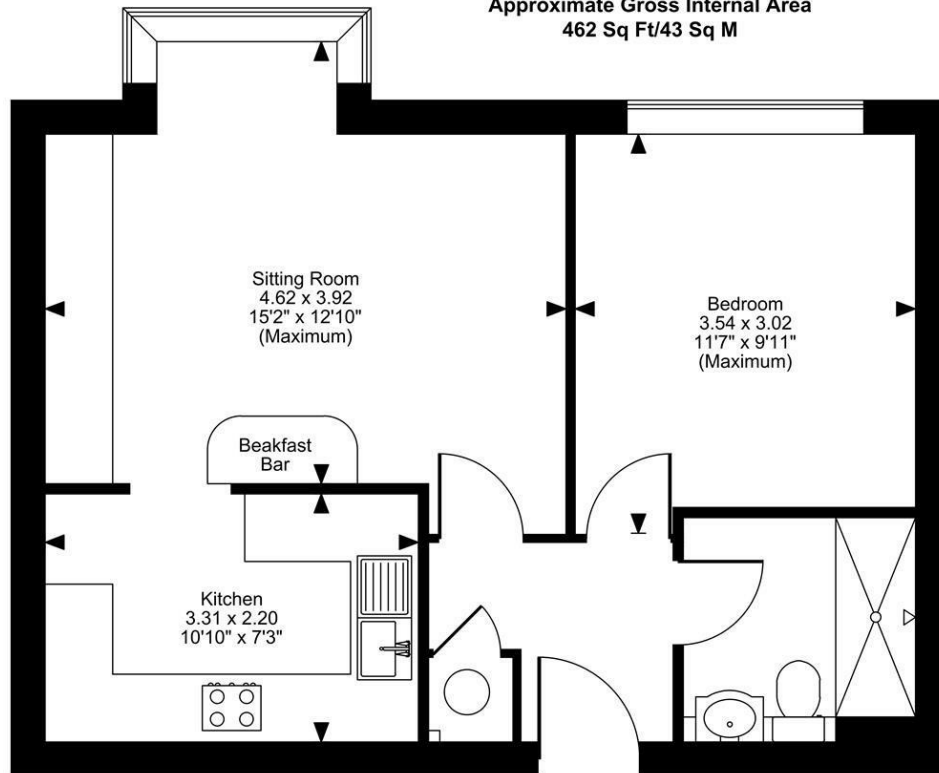
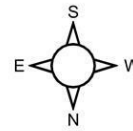

First Floor

FOR ILLUSTRATIVE PURPOSES ONLY - NOT TO SCALE

The position & size of doors, windows, appliances and other features are approximate only.
© ehouse. Unauthorised reproduction prohibited. Drawing ref. dig/8687697/SAP

