



12 Woodfield Gardens, Christchurch BH23 4QA

£547,000

Mitchells

1963 — TODAY



Woodfield Gardens, Christchurch

An immaculate property that had been thoroughly refurbished/ extended in recent years. The detached bungalow in a smart contemporary style with accommodation approaching 1200sqft.

The bungalow is situated in this popular residential area with open outlook to the front with easily maintained gardens enjoying all day sunshine and is just a short stroll to the local shops at Saulflands.



The Property

- Spacious three bedroom detached bungalow
- Two smart bath/shower rooms
- Stylish open plan kitchen/dining/living room with access onto the garden
- Large second reception room perfect as a another sitting room
- A lovely sunny south facing easily maintained rear garden
- Gas fired central heating & upvc double glazing
- Off road parking for several cars
- Walking distance to Wingfields recreation ground and the local shops at Saulflands
- Hinton Admiral main line railway station is just around the corner
- Highcliffe school catchment area





Location



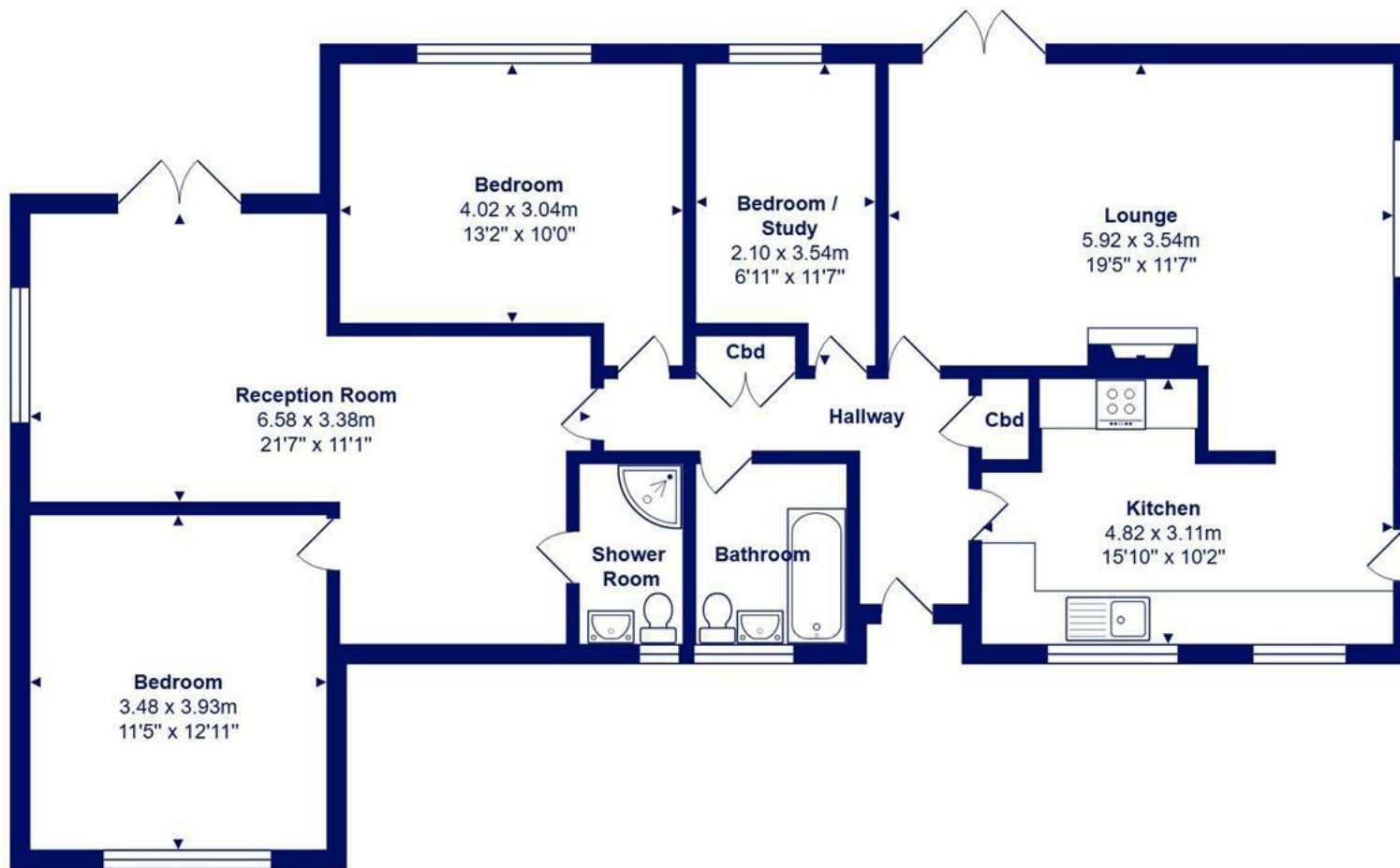

Total Area: 110.2 m² ... 1186 ft²

All measurements are approximate and for display purposes only





www.mitchells.uk.com
Highcliffe@mitchells.uk.com
01425 272206

Highcliffe
284 Lymington Road
Highcliffe
Christchurch
BH23 5ET

