



LANG TOWN
& COUNTRY

6 Peverell Terrace, Peverell, Plymouth, Devon, PL3 4JL



Offers Over £300,000



Nestled quietly in a charming and secluded setting, this enchanting 19th-century cottage is brimming with character and timeless charm. Discreetly positioned in the ever-popular Peverell area, it perfectly balances tranquillity with convenience—just a short stroll from Hyde Park's vibrant shopping parade, within easy reach of excellent schools including Hyde Park Primary School and moments from the open green spaces of Central Park. Plymouth City Centre and Drakes Circus is a 20-minute walk away.

One of only eight cottages, this hidden gem sits set back from the road, privately positioned behind a fence. A gate leads you to a pathway that opens into a delightful south facing front garden, creating a warm and inviting first impression. The front garden is well stocked with Spring flowers, rose bushes, patio area an expansive lawned area which is perfect for summer evenings, BBQ's or al fresco dining.

Inside, the home offers a light and airy lounge with fitted blinds and curtains, alongside a spacious kitchen/diner where French doors open out to the enclosed rear garden—ideal for both relaxing and entertaining. The courtyard garden also provides access to a useful utility area, an outside WC, and additional garden storage. A rear gate leads to a pathway connecting to the service lane behind, offering both practicality and an added sense of security.

Upstairs, there are three bedrooms—two doubles and a single. The front-facing double enjoys particularly pleasant views, stretching across Plymouth Sound, East Cornwall including Mount Edgcombe and Rame Head. A well-appointed family bathroom completes the accommodation, featuring both a separate bath and shower cubicle, along with a wash hand basin and WC.

Offered to the market chain free, this charming cottage presents an extremely rare opportunity to acquire a peaceful yet well-connected home full of character.



To view this property call Lang Town & Country Estate Agents on 01752 256000.



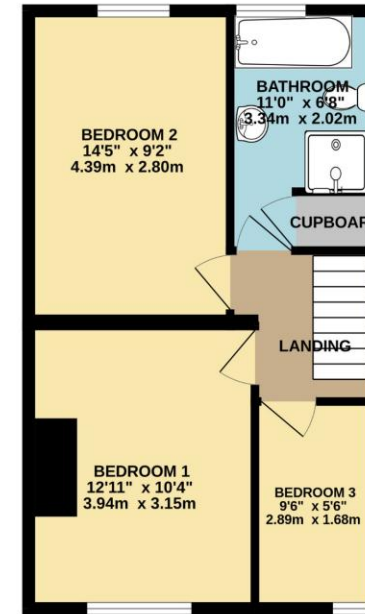
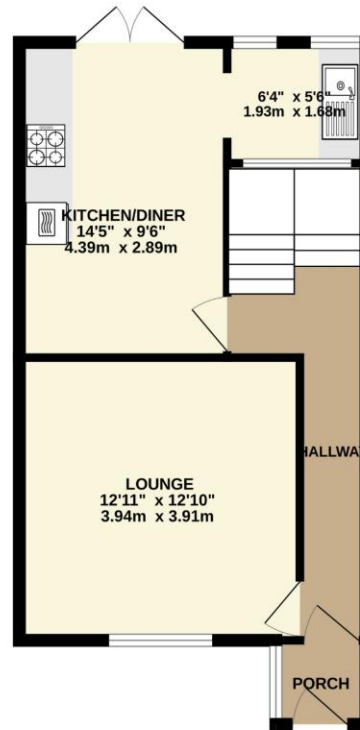
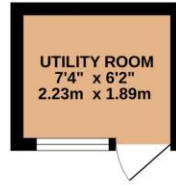

TOTAL FLOOR AREA : 927 sq.ft. (86.1 sq.m.) approx.
 Whilst every attempt has been made to ensure the accuracy of the floorplan contained here, measurements of doors, windows, rooms and any other items are approximate and no responsibility is taken for any error, omission or mis-statement. This plan is for illustrative purposes only and should be used as such by any prospective purchaser. The services, systems and appliances shown have not been tested and no guarantee as to their operability or efficiency can be given.
 Made with Metropix ©2026



Lang Town & Country
 6 Mannamead Road
 Plymouth
 PL4 7AA
 Tel: 01752 256000
 Email: property@langtownandcountry.com
www.langtownandcountry.com

Lang Town & Country endeavour to ensure the accuracy of property details produced and displayed, we have not tested any apparatus, equipment, fixtures, fittings or services and so cannot verify that they are connected, in working order or fit for purpose. A buyer must check the availability of any property and make an appointment to view before embarking on any journey to see a property.

