 2

Bedrooms

 1

Bathroom



***** CASH BUYERS ONLY ***** This two-bedroom maisonette in Harrow offers a practical layout with one bathroom and two reception rooms. The property includes a compact kitchen and a well-sized living area, providing a comfortable living space. Located on Masons Avenue, it is conveniently positioned for access to local amenities and transport links.

***** CASH BUYERS ONLY ***** Located in the heart of Harrow, this two-bedroom maisonette on Masons Avenue offers a practical living space. The property features one bathroom and two reception rooms, providing ample space for both relaxation and entertainment. The compact kitchen is equipped with essential appliances, including an oven and washing machine, ensuring convenience for daily living.

The main living area is bright and airy, with large windows allowing natural light to fill the space. The bedrooms are well-proportioned, offering comfortable accommodation. The bathroom is fully tiled and includes a modern suite with a shower, sink, and toilet.

Situated in Harrow, the property benefits from excellent transport links, with easy access to local bus routes and Harrow's train stations. The area offers a variety of amenities, including shops, restaurants, and parks, providing a vibrant community atmosphere.

This maisonette is an ideal choice for those seeking a well-located property in Harrow, offering a blend of comfort and convenience. The property is situated in a residential area, providing a peaceful living environment while being close to the amenities of Harrow.

The Energy Performance Certificate (EPC) details are available upon request, ensuring transparency regarding the property's energy efficiency.

GROUND FLOOR
62 SQ. FT. (5.7 SQ. M.) APPROX.



FIRST FLOOR
665 SQ. FT. (61.5 SQ. M.) APPROX.

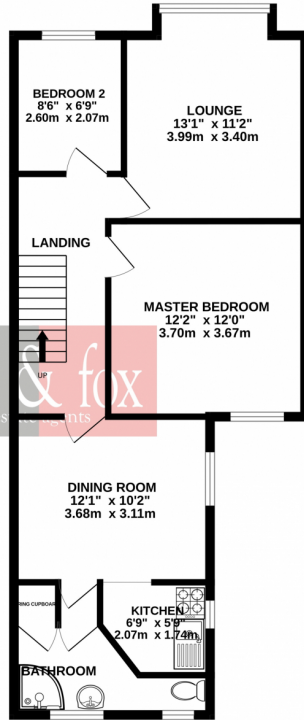

TOTAL FLOOR AREA: 707 sq. ft. (65.7 sq. m.) approx.

Whilst every attempt has been made to ensure the accuracy of the floorplans contained here, measurements of doors, windows, rooms and any other items are approximate and no responsibility is taken for any error, omission or mis-statement. This plan is for illustrative purposes only and should be used as such by any prospective purchaser. The services, systems and appliances shown have not been tested and no guarantee as to their operability or efficiency can be given.
Made with Metropac ©2006.



EPC

Coming soon



