

# Jupiter Heights

Uxbridge • Middlesex • UB10 0TA  
PCM: £1,800 PCM



coopers  
est 1986

Presented to the market this fantastic two double bedroom, top floor apartment. Located at Jupiter Heights on the sought after St Andrews Park, this apartment boasts peaceful location, only a 10 minute walk from Uxbridge town centre and also moments away from Hillingdon ACS and Golf Course.

Includes two generously sized double bedrooms and two modern bathrooms, one being the master bedrooms ensuite. This property simply is a must for those looking to be close to the High Street but in a quiet environment.

Includes allocated parking.

Two Double Bedrooms

Two Bathrooms

Allocated Parking

Close to ACS School

Walking Distance to Uxbridge Town Centre

Council Tax Band C

Nearby to Hillingdon Hospital

Fully Fitted Kitchen with Appliances

Great Transport Links

Close to A40/M40

### Available Date

31st July 2026



GROUND FLOOR  
776 sq.ft. (72.1 sq.m.) approx.

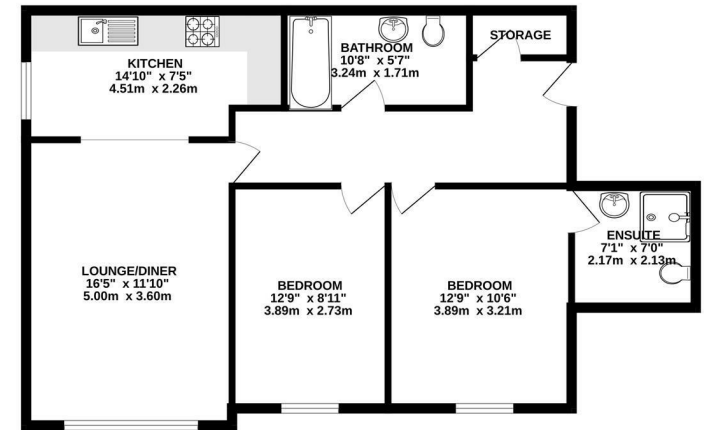

TOTAL FLOOR AREA - 776 sq.ft. (72.1 sq.m.) approx.  
Whilst every attempt has been made to ensure the accuracy of the floorplan contained here, measurements of each element, there are any other items are approximate and no responsibility is taken for any error, omission or mis-statement. This plan is for illustrative purposes only and should be used as such by any prospective purchaser. The windows, doors and appliances shown have not been tested and no guarantee as to their operability or efficiency can be given.  
Made with Homestyler ©2025



**coopers**  
est 1986

01895 230 103

109 Hillingdon Hill, Hillingdon Village,  
Middlesex, UB10 0JQ  
propertymanagement@coopersresidential.co.uk

CoopersResidential.co.uk

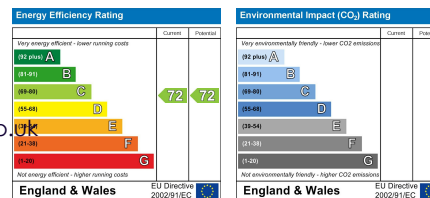

Important Notice: These particulars, whilst believed to be accurate are set out as a general outline only for guidance and do not constitute any part of an offer or contract. Intending purchasers should not rely on them as statements or representation of fact, but must satisfy themselves by inspection or otherwise has the authority to make or give any representation or warranty in respect of the property.