



Honeysuckle Cottage Main Street, Offenham

Guide Price **£425,000**



Honeysuckle Cottage Main Street

Offenham, Evesham

Council Tax band: D

Tenure: Freehold

- GRADE II LISTED 1650'S COTTAGE
- OOZING CHARACTER WITH A WEALTH OF ORIGINAL FEATURES
- THREE BEDROOMS AND TWO BATHROOMS
- MODERNISED THROUGHOUT
- USEFUL ATTIC ROOM
- SITUATED IN THE HEART OF OFFENHAM
- OFF ROAD, GATED PARKING
- WALKING DISTANCE TO VILLAGE AMENITIES





Ground Floor

Approx. 64.7 sq. metres (696.6 sq. feet)

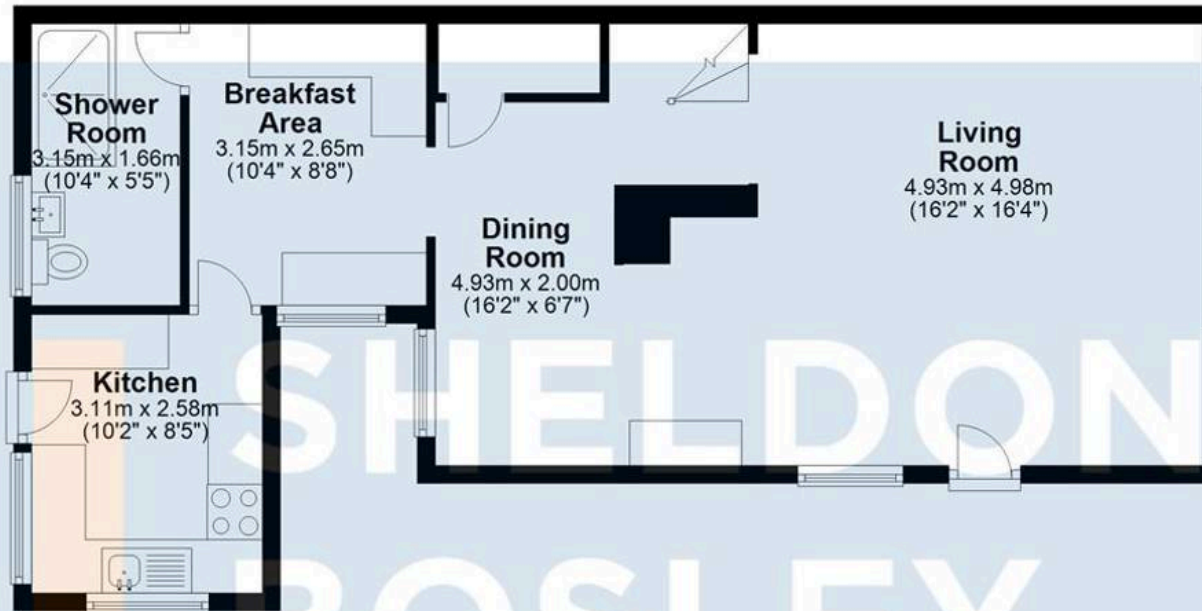

First Floor

Approx. 56.4 sq. metres (607.6 sq. feet)

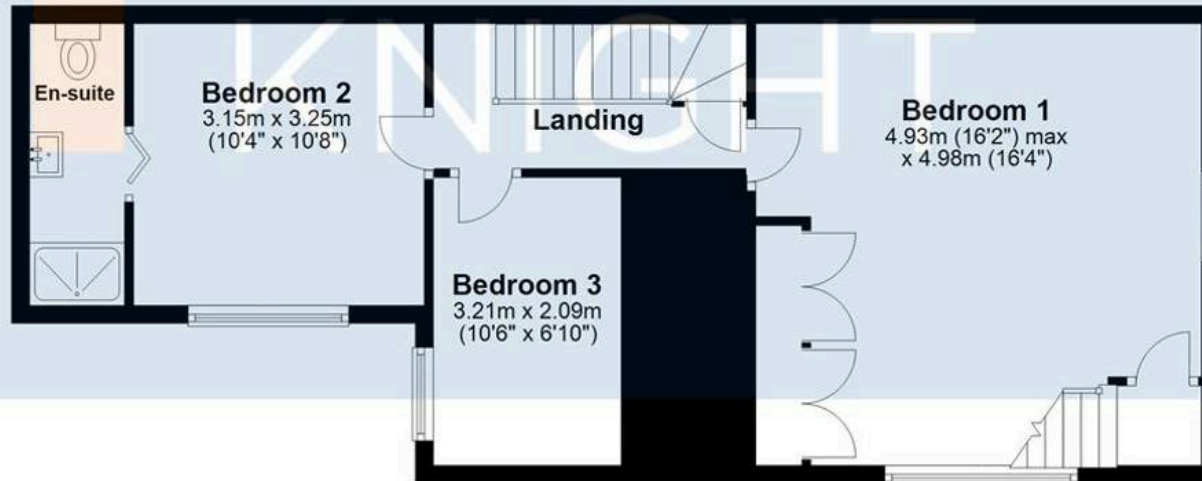

Total area: approx. 121.2 sq. metres (1304.2 sq. feet)

All efforts have been made to ensure that the measurements on this floorplan are accurate however these are for guidance purposes only.
Plan produced using PlanUp.