



COLDHARBOUR LANE, SE5

£400,000

One Double Bedroom
Private South Facing Garden
Raised Ground Floor
Close To Transport
Period Property
Energy Rating: C

@marshandparsons
marshandparsons.co.uk

MARSH &
PARSONS



ABOUT THE PROPERTY

A superb one bedroom flat set over the raised ground floor of an impressive period building boasting a spacious bedroom with built-in wardrobes, a generous living room and a well-fitted kitchen with direct access to a charming south facing patio garden.

The property further benefits from ample period character throughout including solid wooden flooring, cast iron radiators and large double glazed sash windows.

Coldharbour Lane is well positioned for the vast array of shops, cafés and restaurants of both Loughborough Junction and central Brixton with the boutiques of Herne Hill also on the doorstep. The green open spaces of



STEP INSIDE COLDHARBOUR LANE

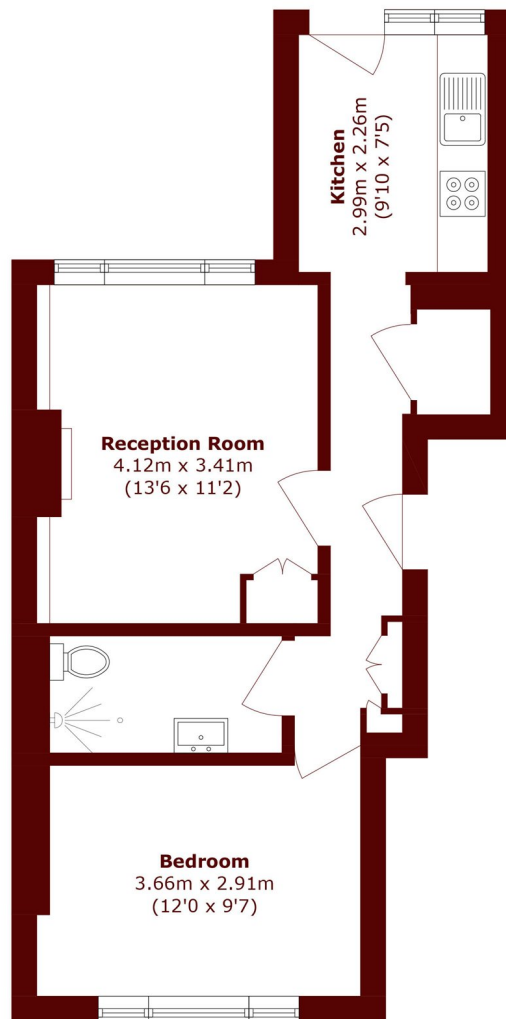

Total area (approx.): 43.5 sq. m (468.2 sq. ft)

Brixton
020 7733 4595

Energy Rating: C We aim to make our particulars both accurate and reliable. However, they are not guaranteed; nor do they form part of an offer or contract. If you require clarification on any points then please contact us, especially if you're traveling some distance to view. Please note that appliances and heating systems have not been tested and therefore no warranties can be given as to their good working order

**MARSH &
PARSONS**