



## FROGMORE, SW18

£400,000

Two bedrooms  
Allocated parking  
Wandsworth park  
Gated development  
No chain  
Close to the river

@marshandparsons  
marshandparsons.co.uk

MARSH &  
PARSONS



# ABOUT THE PROPERTY

A two bedroom ground floor flat set within a gated development.

Hungerford Court is located close to central Wansdworth and just a few minutes from Putney, offering fantastic local amenities, shopping and transport links.



# STEP INSIDE FROGMORE

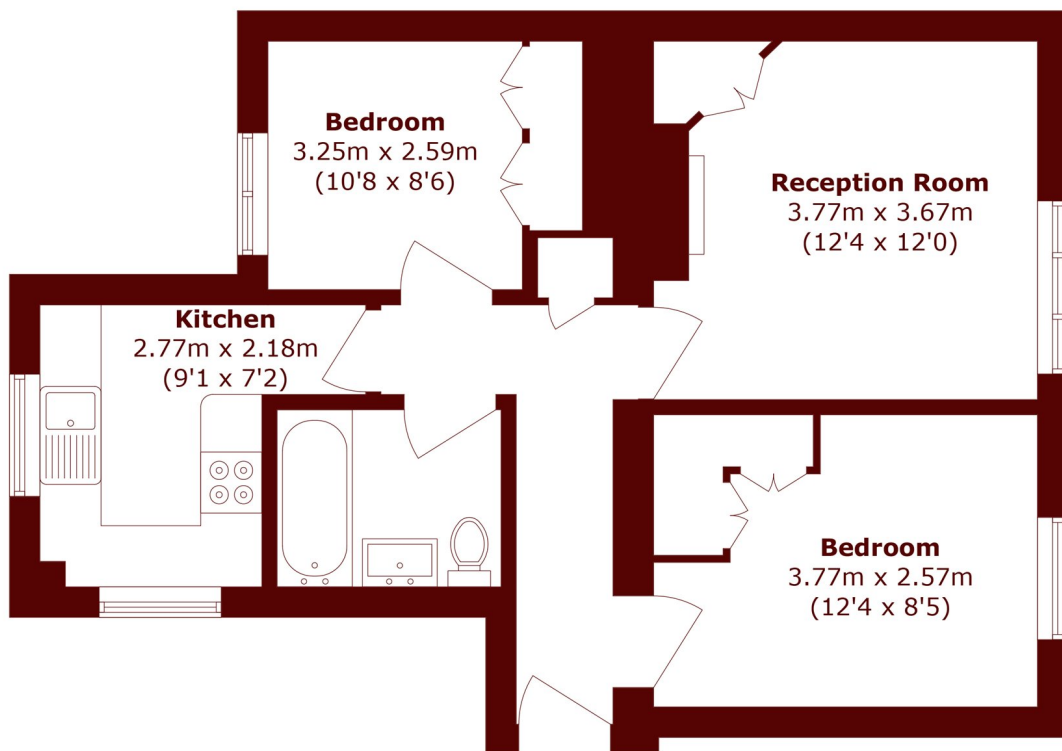

Total area (approx.): 52.9 sq. m (569.4 sq. ft)

**Barnes & East Sheen**  
020 8563 8333

Energy Rating: D We aim to make our particulars both accurate and reliable. However, they are not guaranteed; nor do they form part of an offer or contract. If you require clarification on any points then please contact us, especially if you're traveling some distance to view. Please note that appliances and heating systems have not been tested and therefore no warranties can be given as to their good working order

**MARSH &  
PARSONS**