



Apartment 5 Castle Chambers 5 Clifford Street YO1 9RG

£1,100 PCM

1



1



1



C



This one bedroom first floor apartment is located within this converted building, enjoying a superb position on Clifford Street, just moments from Clifford's Tower and King's Staith, with the city's vibrant amenities on its doorstep. The property is offered on a furnished basis and briefly comprises; Entrance hall with utility cupboard with washer/dryer. Bathroom suite with shower over the bath. Open plan living / kitchen. Kitchen includes integrated induction hob, oven, fridge/freezer and dishwasher. Double bedroom with fitted wardrobes
 Internal bike storage and lifts to all floors
 NO ON SITE PARKING

Available Now

Deposit £1260 / EPC rating D / Council tax Band C

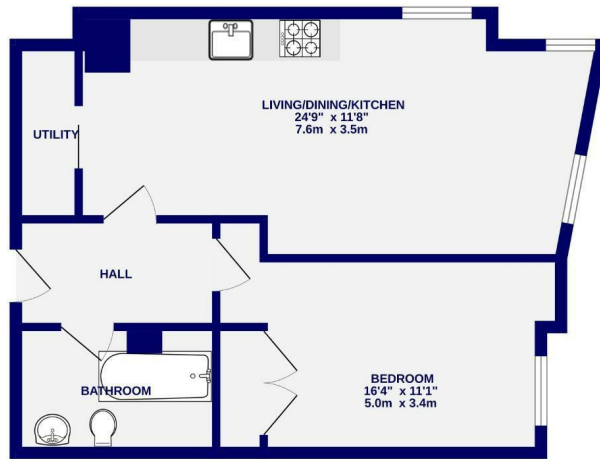

TOTAL FLOOR AREA: 533 sq.ft. (49.6 sq.m.) approx.
 Whilst every effort has been made to ensure the accuracy of the description, measurements of rooms and any other areas are approximate. The above is for guidance only and should not be relied upon for any purpose. The above information is for guidance only and should be used as such for any prospective purchaser. The services, systems and appliances shown here have been checked and are guaranteed as at their operation.
 Made with Metaphor 02/25



Ashtons Lettings

01904 731404

lettings@ashtonsnet.com