

4 Bed House - End Terrace
located in

JR
JOSHUA REED
Estate Agents

65 Park View
Hoddesdon
EN11 8QQ



4



1



3



C

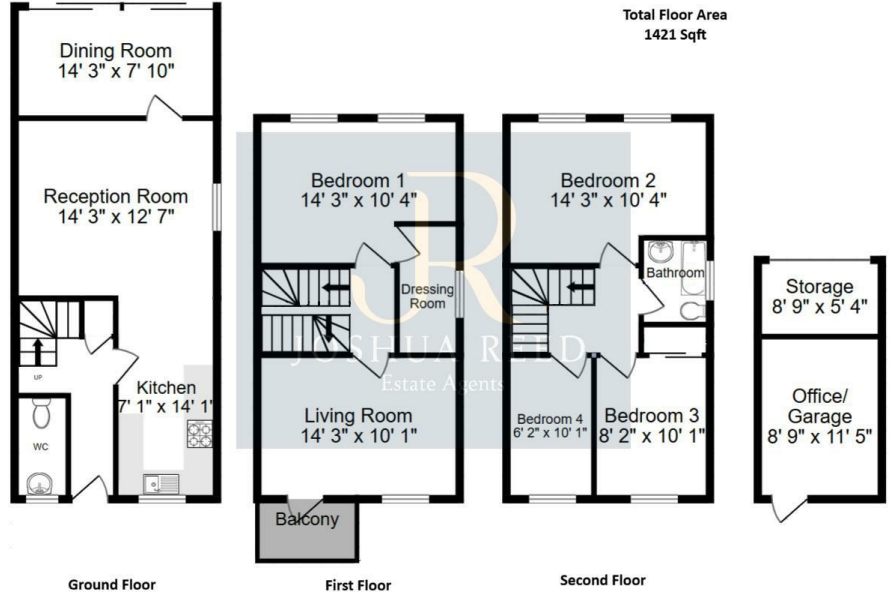

Offers in excess of

£500,000

CONTACT

23-27 Maidenhead Street
Hertford
Hertfordshire
SG14 1DW

EMAIL

josh@joshua-reed.co.uk

TELEPHONE

01992 917388

www.joshua-reed.co.uk

SUMMARY

This extended four bedroom town house is perfectly located for a direct view over Barclay Park with only a short walk away from Hoddesdon Town Centre and local schools. The versatile accommodation features a downstairs cloakroom, re-fitted modern kitchen open plan to the sitting/family room and the extension dining room with bi-folds doors out onto the garden.

To the first floor, you'll find the living room with balcony providing lovely views over Barclay Park, master bedroom suite with dressing room that was originally an ensuite (plumbing/pipework still in place) and three further bedrooms and main bathroom to the top floor.

Externally, the property has fantastic curb appeal with side access leading to the low maintenance rear garden that also has rear access leading to the parking in front of the garage. The garage has been converted into a useable office/studio/playroom also with useful storage.

Rarely available, this property is ready for immediate viewing and is chain free.

DIRECTIONS

