



[www.kings-group.net](http://www.kings-group.net)

25 Silver Street  
Enfield Town EN1 3EF  
Tel: 0208 364 4118

**Magpie Close, Enfield, EN1 4JE**  
**Offers In The Region Of £205,000**

Kings Group – Enfield Town are pleased to present this chain free, top floor one double bedroom flat, set back within a peaceful cul-de-sac in a highly sought after location. This property represents an ideal first-time purchase or excellent investment opportunity.

The accommodation comprises a spacious reception room which flows seamlessly into a fitted kitchen, creating a bright and functional living space. The generous double bedroom benefits from two windows, allowing an abundance of natural light to fill the room. There is also a three piece bathroom suite.

Further benefits include a long lease of approximately 153 years, residents' parking, a security entry phone system, and double glazing throughout. Being situated on the top floor also provides an additional sense of privacy and security.

The property is offered to the market chain free and is conveniently located just under one mile from Turkey Street railway station, providing direct access to Liverpool Street station in approximately 35 minutes. Local bus routes are within walking distance, and commuters will appreciate the easy access to the A10 road, connecting swiftly to the M25 motorway and A406 North Circular Road.

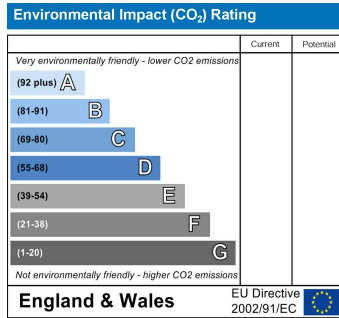
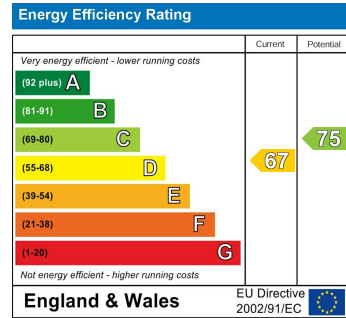

## Second Floor

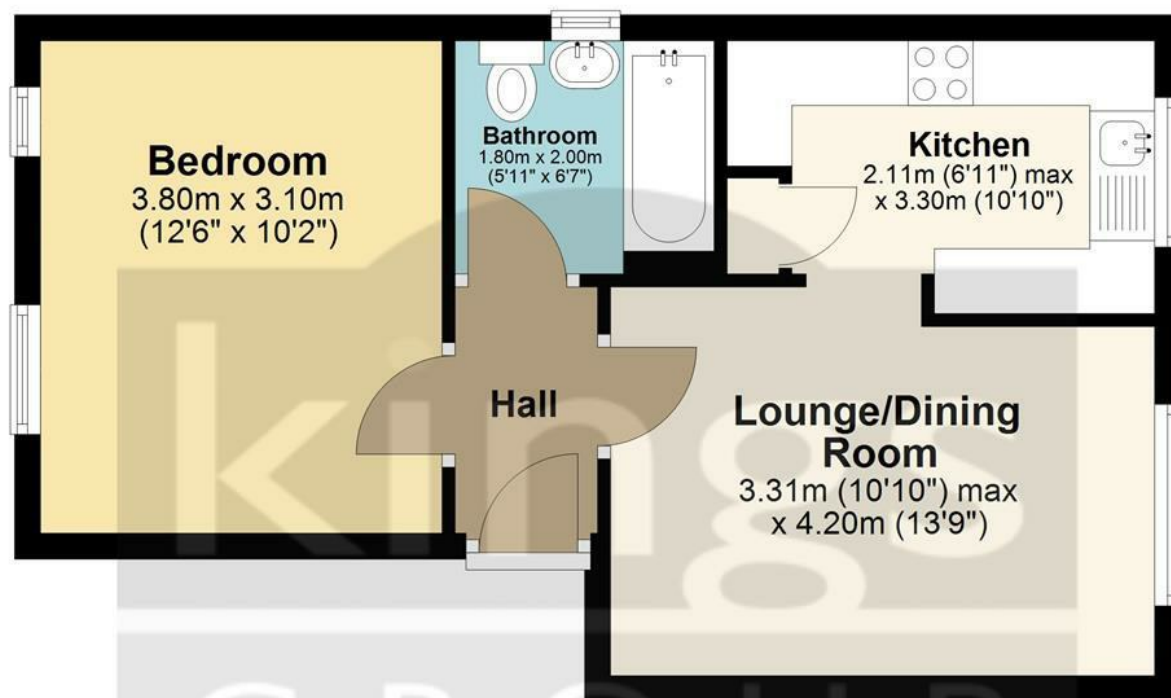
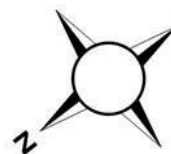

Total area: approx. 37.9 sq. metres (408.4 sq. feet)

All measurements have been taken as a guide to prospective buyers only and are not precise. This plan is for illustrative purposes only and no responsibility for any error, omission or misstatement. The services, systems and appliances shown have not been tested and no guarantee as to their operability or efficiency can be given.

Measurements may have been taken from the widest area and may include wardrobe/cupboard space. No guarantee is given to any measurements including total areas. Buyers are advised to take their own measurements.

© @modephotouk | www.modephoto.co.uk  
Plan produced using PlanUp. □

## Magpie Close

Associated Offices in London, Essex and Hertfordshire  
Kings Head Office Tudor Lodge, Burton Lane, Goffs Oak, Hertfordshire EN7 6SY Tel: 01707-872000





kings  
GROUP



kings  
GROUP

