



3 Gladstone Street

Anstey, Leicester, LE7 7BT

Offers Over £200,000

A traditional palisaded terraced offered for sale with no chain and situated in a popular village location close to shops and open countryside, benefitting from gas central heating and UPVC double glazing to all windows and external doors. Comprising lounge, dining room and refitted kitchen. Landing, 2 bedrooms and bathroom. Garden and off road parking to rear.

- Off Road Parking
- Mature Garden
- No Chain
- Ideal First Time Buy
- Two Reception Rooms
- Two Double Bedrooms

Viewing

Please contact our Berkley Leicester Office on 0116 2544755 if you wish to arrange a viewing appointment for this property or require further information.



Floor Plan

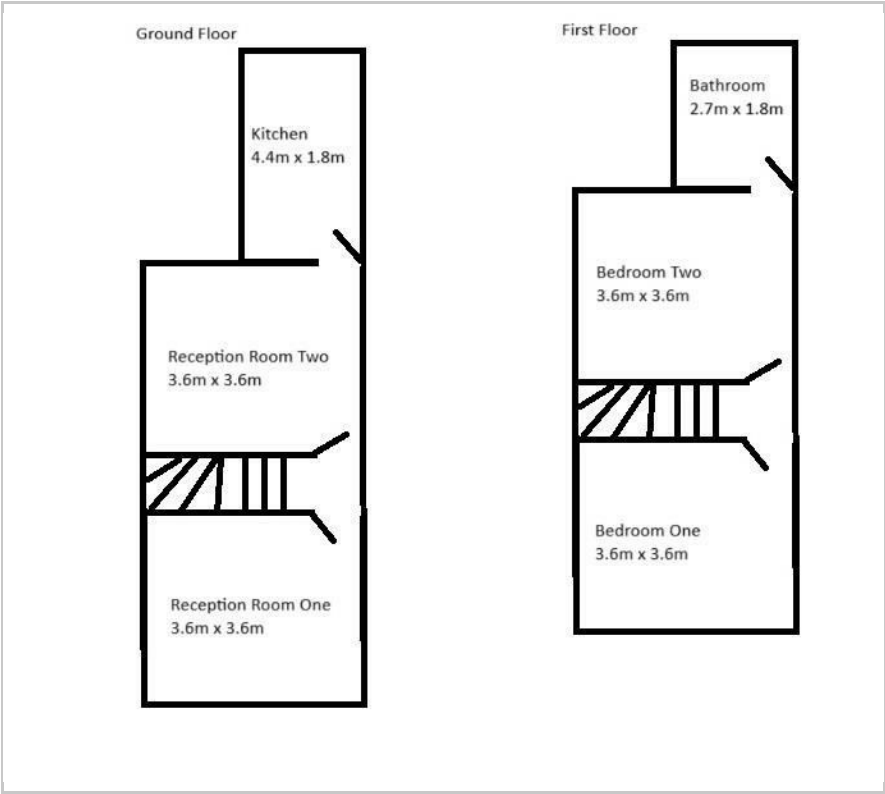

Area Map



Energy Efficiency Graph

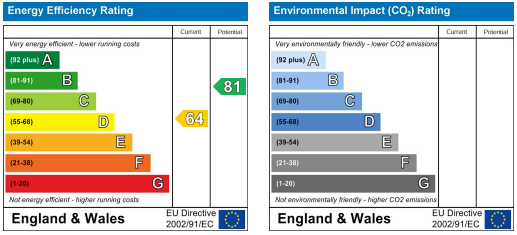

These particulars, whilst believed to be accurate are set out as a general outline only for guidance and do not constitute any part of an offer or contract. Intending purchasers should not rely on them as statements of representation of fact, but must satisfy themselves by inspection or otherwise as to their accuracy. No person in this firms employment has the authority to make or give any representation or warranty in respect of the property.