



**POOLE
TOWNSEND**

Riverdale Court, Kendal, LA9 7LQ

£360,000

🛏️ 2 🪑 2 🚗 1



- Impressive Ground-Floor Apartment
- Easy Access To Local Amenities
- Private Balcony
- Tranquil Riverside Setting
- Council Tax Band: E
- Two Double Bedrooms
- Open-Plan Lounge And Dining Area
- Allocated Parking and Garage
- No Chain
- EPC Rating: C



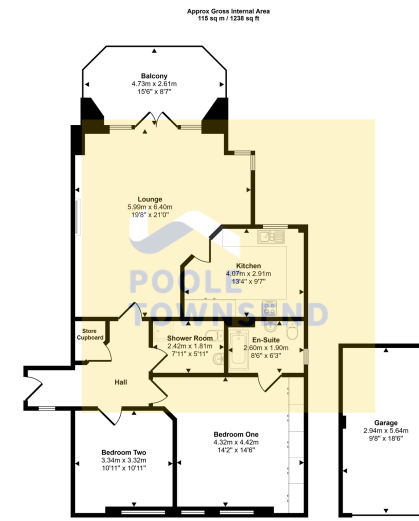

Floorplan
Approx 90 sq m / 1000 sq ft

Garage
Approx 17 sq m / 179 sq ft

This floorplan is only for illustrative purposes and is not to scale. Measurements of rooms, doors, windows, and any items are approximate and no responsibility is taken for any error, omission or misstatement. Lines of items such as bathroom suites are representative only and may not look like the real items. Made with Magic Drawings 300.

Nestled on the banks of the River Kent, Riverdale Court is an exclusive and sought-after residential development, ideally positioned for easy access to local amenities and transport links. Naturally bright and airy, this impressive ground-floor apartment offers spacious, thoughtfully designed accommodation and is offered with no onward chain. At its heart is a generous open-plan lounge and dining area, with glazed doors opening onto a private balcony, perfect for enjoying the tranquil riverside setting. The modern fitted kitchen is well-equipped for contemporary living, while two double bedrooms provide comfortable sleeping quarters, including a master bedroom with en-suite facilities and a separate stylish shower room. Additional benefits include allocated parking, a private garage, and secure, peaceful surroundings, making this an ideal home for couples, retirees, or those seeking a charming

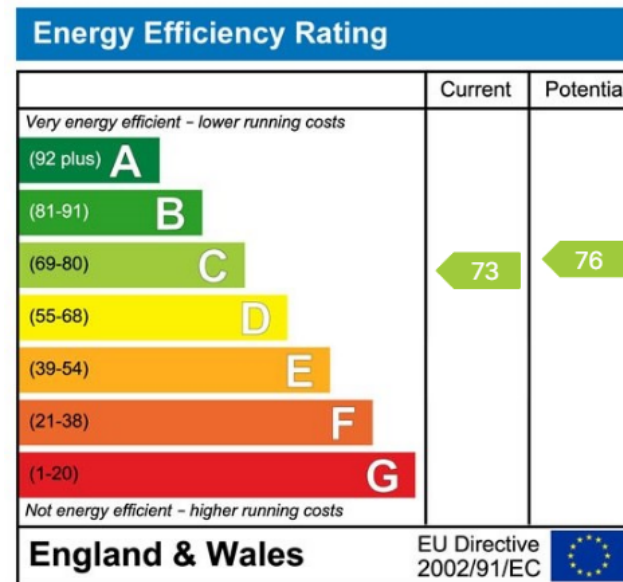

Visit us at
www.pooletownsend.co.uk
enquiries@pooletownsend.co.uk

We are open
 Monday – Friday 9.00 – 5.00
 Saturday 9.00 – 1.00

Barrow 01229 811811
 Ulverston 01229 588111
 Grange 015395 33316
 Kendal 01539 734455
 Milnthorpe 015395 62044