



20 Westmead, Windsor, SL4 3NL
£325,000

 **HORLER**

20 Westmead, Windsor, SL4 3NL

Situated in Westmead, Windsor, this generously sized ground floor maisonette offers a perfect blend of comfort and convenience. With two double bedrooms, this property is ideal for small families, couples, or individuals seeking a peaceful retreat close to local amenities and school.

In summary, this large two-bedroom maisonette in Westmead presents a fantastic opportunity for those seeking a comfortable home in a desirable location. With its spacious living areas, private garden, and proximity to essential amenities, it is a property not to be missed.

Call today on 01753 621234 to arrange a viewing.



Property Summary

Situated in Westmead, Windsor, this generously sized ground floor maisonette offers a perfect blend of comfort and convenience. With two double bedrooms, this property is ideal for small families, couples, or individuals seeking a peaceful retreat close to local amenities and schools.

Upon entering, you are welcomed into a spacious living room; the well-appointed kitchen is functional and offers ample space for culinary pursuits. The family bathroom is conveniently located, serving both bedrooms with ease.

One of the standout features of this maisonette is the lovely rear garden, which boasts a small patio area, perfect for enjoying a morning coffee or evening gatherings. The garden is predominantly laid to lawn, providing a wonderful space for children to play or for gardening enthusiasts to cultivate their green thumbs. Additionally, a wooden shed offers practical storage solutions for outdoor equipment.

The property's location is particularly advantageous, as it is within easy reach of Windsor town centre, where you can explore a variety of shops, restaurants, and cultural attractions. The nearby schools make it an excellent choice for families looking to settle in a vibrant community.

In summary, this large two-bedroom maisonette in Westmead presents a fantastic opportunity for those seeking a comfortable home in a desirable location. With its spacious living areas, private garden, and proximity to essential amenities, it is a property not to be missed.

General Information

Council Tax Band 'C'

Service Charge TBC

Legal Note

Although these particulars are thought to be materially correct their accuracy cannot be guaranteed and they do not form part of any contract





Westmead SL4

Approximate Gross Internal Floor Area = 78.5 sq m / 845 sq ft
(Including Outbuilding)

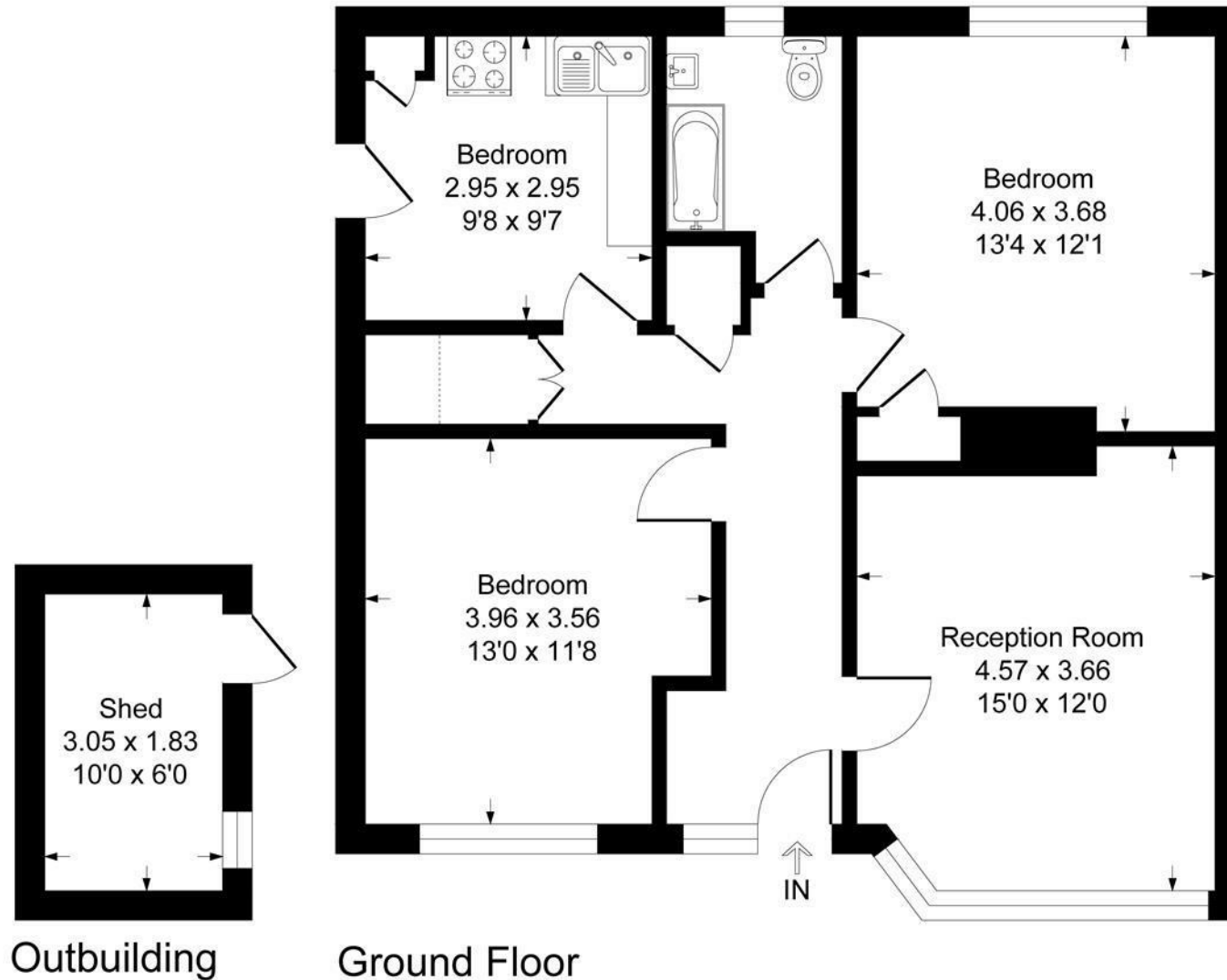

Illustration for identification purposes only, measurements are approximate, not to scale.
Produced By Esjay Property Marketing