



LEYSFIELD ROAD, W12

£425,000

Ground Floor
Great Potential
Share Of Freehold
Large Windows
High Ceilings
Good Transport Links

@marshandparsons
marshandparsons.co.uk

MARSH &
PARSONS

ABOUT THE PROPERTY

A ground floor one-bedroom, one-bathroom period conversion offering excellent scope to improve and add value. The property benefits from a share of freehold and retains attractive period proportions, including high ceilings and large windows that flood the space with natural light and create a bright, airy feel throughout. The accommodation is well arranged, comprising a spacious reception room with ample space for both living and dining, a separate kitchen, a generous double bedroom, and a bathroom. The layout provides a solid foundation for refurbishment, allowing a purchaser to modernise and personalise to their own taste. Tucked away in Shepherd's Bush, the property enjoys a peaceful residential setting while remaining close to excellent transport links and a







STEP INSIDE LEYSFIELD ROAD

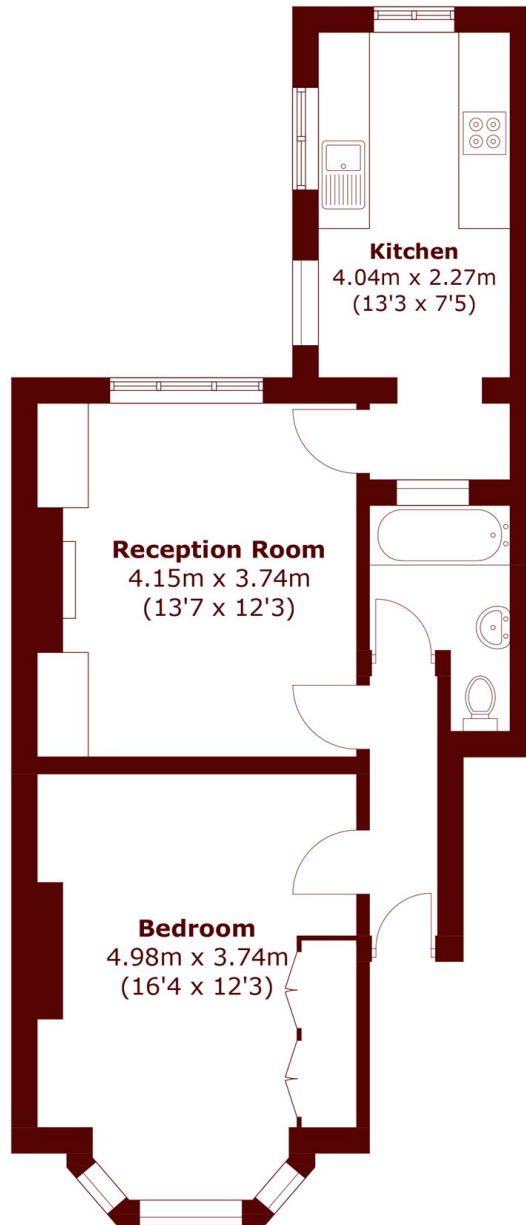

Total area (approx.): 52.7 sq. m (567.3 sq. ft)

Askew Road
020 8102 0123

Energy Rating: D We aim to make our particulars both accurate and reliable. However, they are not guaranteed; nor do they form part of an offer or contract. If you require clarification on any points then please contact us, especially if you're traveling some distance to view. Please note that appliances and heating systems have not been tested and therefore no warranties can be given as to their good working order

MARSH &
PARSONS