



HUNTERS[®]

HERE TO GET *you* THERE

Crimond Avenue, Dymchurch | Asking Price £525,000
Call us today on 01303 261557



Thinking of Selling?

If you are thinking of selling your home or just curious to discover the value of your property, Hunters would be pleased to provide free, no obligation sales and marketing advice. Even if your home is outside the area covered by our local offices we can arrange a Market Appraisal through our national network of Hunters estate agents.

A substantial and versatile detached bungalow, occupying a generous plot in a desirable rural setting on the outskirts of Dymchurch, enjoying far-reaching countryside views and offering approximately 2,100 sq. ft. of well-proportioned accommodation.

The property is arranged around a central hallway, providing a practical and balanced layout ideal for family living or multi-generational use. The principal reception space is a spacious sitting room, measuring over 18ft, offering a bright and comfortable environment with ample room for both seating and entertaining.

A separate dining room, extending to over 18ft in length, provides an excellent formal entertaining space and benefits from direct access to the adjoining kitchen/breakfast room. The kitchen is well-positioned and offers a range of wall and base units, with space for informal dining, creating a sociable hub of the home.

The bungalow offers a total of seven bedrooms, providing exceptional flexibility. The principal bedroom suite is particularly generous, featuring built-in storage and an en suite shower room. Several further double bedrooms, including two measuring approximately 17ft in length, offer excellent proportions, while additional bedrooms can be utilised as guest accommodation, study space, or hobby rooms depending on requirements. A family bathroom, separate shower room, and additional WC serve the remaining accommodation, enhancing convenience for larger households.

Externally, the property benefits from its rural positioning, with attractive open views across the surrounding countryside. The property offers driveway offering ample parking with access to a single garage and workshop. The garden is mainly laid to lawn with a variety of mature flower and shrub borders and large patio area.

This is a rare opportunity to acquire a spacious and adaptable bungalow in a semi-rural location, ideally suited to buyers seeking generous accommodation with countryside outlooks.

Located on the Kent coastline, Dymchurch is a popular seaside village known for its long stretches of sandy beach and relaxed coastal lifestyle. The village offers a range of everyday amenities including local shops, cafés, public houses and a primary school, making it well-suited to families and those seeking a quieter pace of life.

One of Dymchurch's key attractions is its award-winning beach, providing miles of open shoreline ideal for walking, leisure activities and enjoying sea views. The area also benefits from easy access to the historic Romney Hythe and Dymchurch Railway, offering scenic journeys along the coast and countryside.

For wider facilities, the nearby towns of Hythe and New Romney provide a broader selection of shops, supermarkets and services. Transport links are convenient, with road connections to Folkestone, where high-speed rail services offer access to London.

Combining coastal charm with practical amenities, Dymchurch remains a sought-after location for both permanent living and holiday homes.

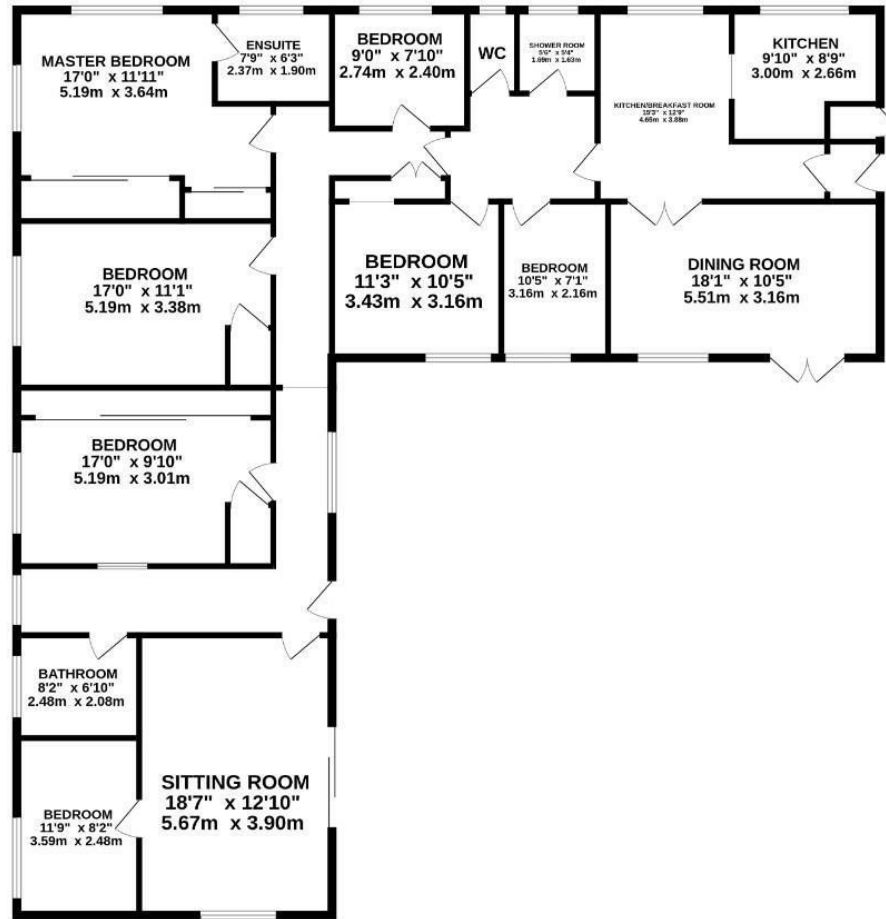

TOTAL FLOOR AREA : 2100 sq.ft. (195.1 sq.m.) approx.

Whilst every attempt has been made to ensure the accuracy of the floorplan contained here, measurements of doors, windows, rooms and any other items are approximate and no responsibility is taken for any error, omission or mis-statement. This plan is for illustrative purposes only and should be used as such by any prospective purchaser. The services, systems and appliances shown have not been tested and no guarantee as to their operability or efficiency can be given.
Made with Metropix ©2026

These particulars are intended to give a fair and reliable description of the property but no responsibility for any inaccuracy or error can be accepted and do not constitute an offer or contract. We have not tested any services or appliances (including central heating if fitted) referred to in these particulars and the purchasers are advised to satisfy themselves as to the working order and condition. If a property is unoccupied at any time there may be reconnection charges for any switched off/disconnected or drained services or appliances - All measurements are approximate.

156a High Street, Hythe, CT21 5JU | 01303 261557 | hythe@hunters.com

