



Hodder Drive, UB6

£761 pw (£3,300 pcm)

An immaculately presented, spacious four bedroom home featuring off-street parking, a private garden and an outdoor studio/office with its own bathroom. The property also offers a double reception room, underfloor heating, modern kitchen, two bathrooms, downstairs WC and hallway.

The property is located on Hodder Drive in Perivale, close to various transport links and amenities.

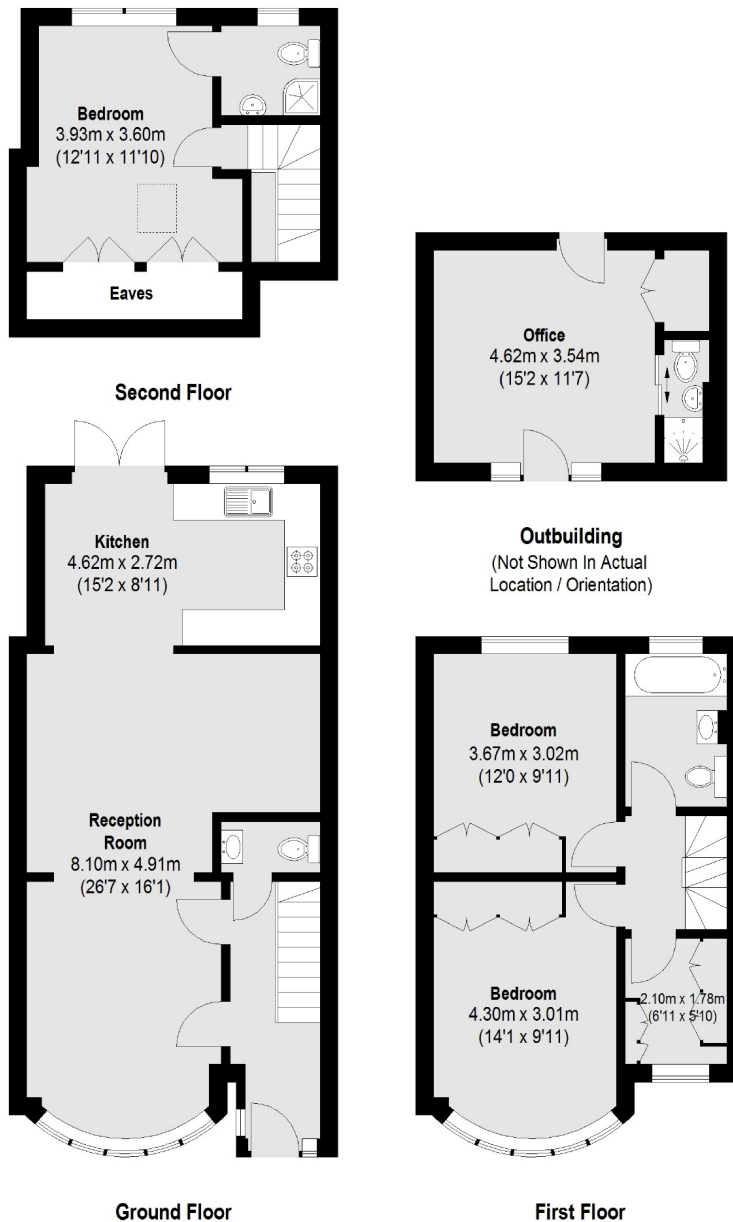

Total area (approx.): 107.47 sq. m (1156 Sq. ft)
 Outbuilding: 16.67 sq. m (179 Sq. ft)
 (Excluding Eaves)

Robertson Smith & Kempson Ealing Lettings
 1 The Broadway,
 London, W5 2NT
 020 8840 7885
ealinglettings@robertsonsmithandkempson.co.uk

Energy Rating: D. We aim to make our particulars both accurate and reliable. However they are not guaranteed; nor do they form part of an offer or contract. If you require clarification on any points then please contact us, especially if you're traveling some distance to view. Please note that appliances and heating systems have not been tested and therefore no warranties can be given as to their good working order.