



The Copse
St George, Weston Super Mare BS22













Offered to the market with no onward chain, this spacious and well-presented four-bedroom townhouse provides versatile accommodation arranged over three floors, making it ideal for growing families or those needing flexible living space.

The ground floor offers a modern and stylish kitchen, complemented by a bright and comfortable living room which flows through to a conservatory, creating additional reception space perfect for relaxing or entertaining. A convenient cloakroom completes the ground floor.

Across the upper floors, the property features four double bedrooms, including a main bedroom with ensuite, alongside a contemporary family bathroom. The layout offers excellent flexibility for family life, guest accommodation or working from home.

Externally, the home benefits from a westerly-facing rear garden, ideal for enjoying the afternoon and evening sun. There is also a garage and allocated parking, adding further practicality.

The Copse is set within a popular and well-established residential area of St George in Weston-super-Mare, known for its family-friendly feel and convenient access to local amenities. Nearby you'll find shops, schools and green spaces, while Weston town centre and the seafront are just a short drive away.

For commuters, the property is well positioned with easy access to the M5 and main transport links, as well as Weston-super-Mare train station providing direct routes to Bristol and beyond.



GROUND FLOOR
619 sq.ft. (57.5 sq.m.) approx.

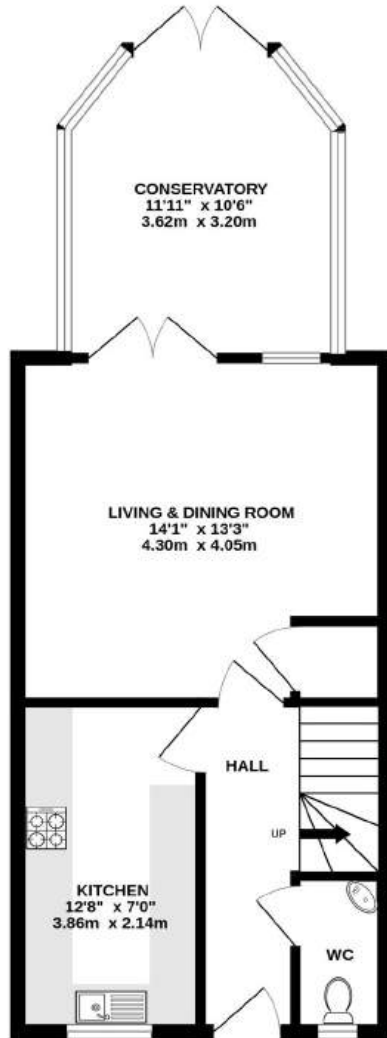
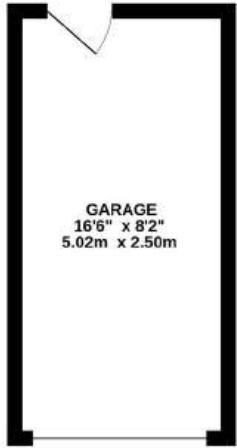

1ST FLOOR
366 sq.ft. (34.0 sq.m.) approx.

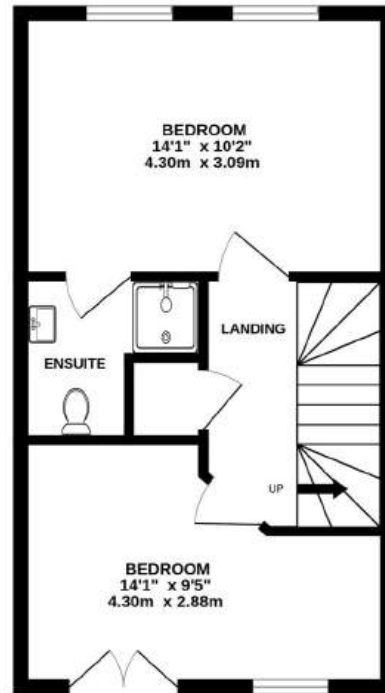

2ND FLOOR
366 sq.ft. (34.0 sq.m.) approx.

