

## Phoenix Way, SW18

£350,000

An impressive one double bedroom apartment on the sought-after Phoenix Way. Offering an open plan reception, kitchen and dining area along with a modern family bathroom. Residents also benefit from a secure communal entrance and communal garden.

Phoenix Way is conveniently located just off St John's Hill and Northcote Road, offering a wide range of local amenities, and is moments from Wandsworth Common. Excellent transport links are available just a stroll away at Clapham Junction Station.

### Features

- Open Plan Kitchen/Reception
- Double Bedroom
- Family Bathroom
- Communal Garden
- Secure Building
- Superb Location

# Phoenix Way, London, SW18

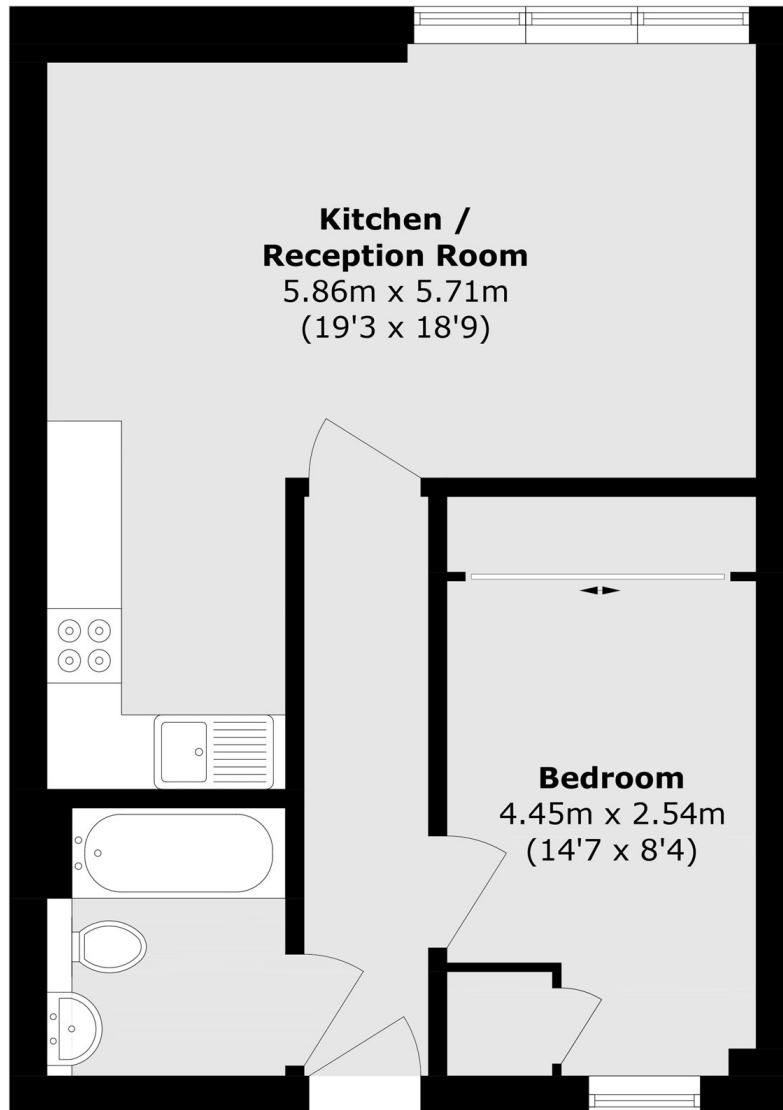

Total area (approx.): 47.5 sq. m (511.2 sq. ft)