



**Spencer Crescent, Diss IP22 4UF**

**welcome to**

## **Spencer Crescent, Diss**

This property is a must-see for those seeking a comfortable and conveniently located home in Diss.

### **Accommodation**

#### **Entrance Hall**

Laminate flooring and radiator.

#### **Cloakroom**

Lino flooring, low level WC, wash hand basin, radiator and fuse board.

#### **Kitchen**

8' 5" x 6' 7" ( 2.57m x 2.01m )

Base and eye level units with adjoining worktop. Integrated oven with gas hob and extractor hood over. Enclosed wall mounted boiler. Space for fridge/freezer and washing machine. Sink with mixer tap over. Window to front aspect.

#### **Living Room**

14' 2" x 13' 1" ( 4.32m x 3.99m )

Laminate flooring, under stairs cupboard, radiator and French doors into rear garden.

#### **Landing**

Carpeted flooring and loft hatch.

#### **Bedroom One**

11' 6" x 10' 2" ( 3.51m x 3.10m )

Carpeted flooring, storage cupboard, radiator and two windows to front aspect.

#### **Bedroom Two**

12' 3" x 6' 9" ( 3.73m x 2.06m )

Carpeted flooring, radiator and window to rear aspect.

#### **Bathroom**

Laminate flooring, P shape bath with shower over, wash hand basin, low level WC, radiator and window to rear aspect.

### **Loft Space**

Partially boarded.

### **Outside**

#### **Front Garden**

Hedge enclosed with path to front door.

#### **Rear Garden**

Fence enclosed, mostly laid with artificial grass, shed and Summerhouse to remain and patio area. Gate to rear providing access to two parking spaces.

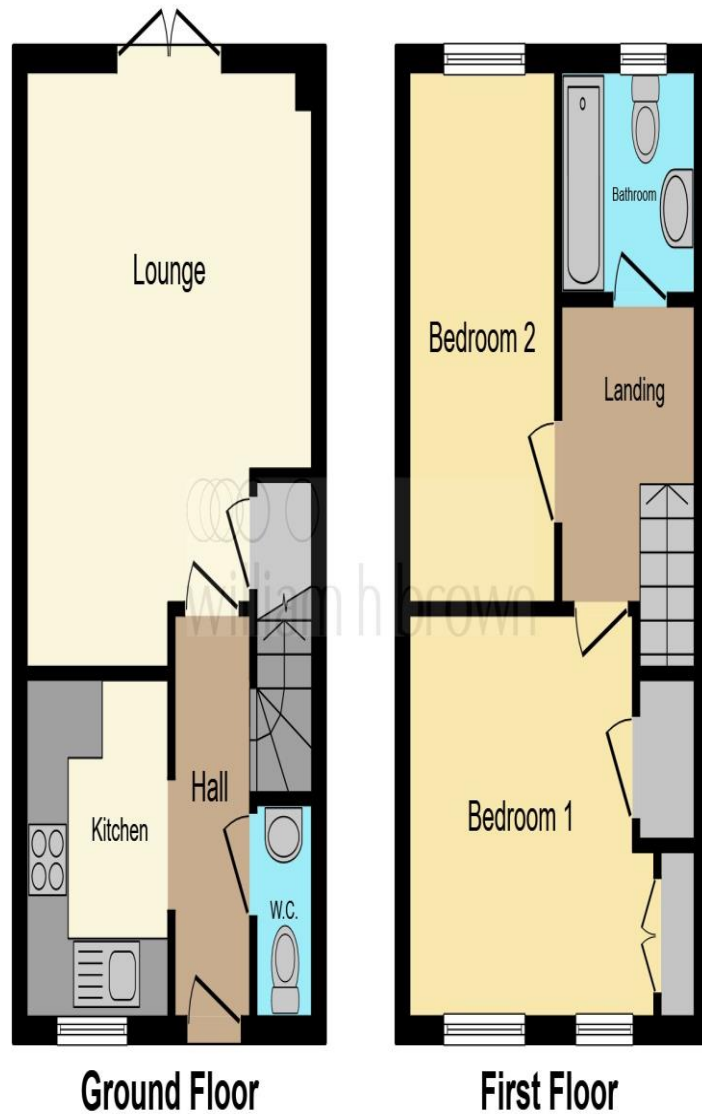

This floor plan is for illustrative purposes only. It is not drawn to scale. Any measurements, floor areas (including any total floor area), openings and orientation are approximate. No details are guaranteed, they cannot be relied upon for any purpose and they do not form part of any agreement. No liability is taken for any error, omission or misstatement. A party must rely upon its own inspection(s). Powered by [www.focalagent.com](http://www.focalagent.com)



**welcome to**  
**Spencer Crescent,**  
**Diss**

- End Terrace House
- Two Bedrooms
- First Floor Bathroom & Ground Floor Cloakroom
- Living Room To Rear With French Doors
- Two Allocated Parking Spaces

Tenure: Freehold EPC Rating: C  
Council Tax Band: B

offers over  
**£200,000**



**view this property online** [williamhbrown.co.uk/Property/DSS111137](http://williamhbrown.co.uk/Property/DSS111137)



Property Ref:  
DSS111137 - 0004

1. MONEY LAUNDERING REGULATIONS Intending purchasers will be asked to produce identification documentation at a later stage and we would ask for your co-operation in order that there is no delay in agreeing the sale. 2. These particulars do not constitute part or all of an offer or contract. 3. The measurements indicated are supplied for guidance only and as such must be considered incorrect. Potential buyers are advised to recheck measurements before committing to any expense. 4. We have not tested any apparatus, equipment, fixtures or services and it is in the buyers interest to check the working condition of any appliances. 5. Where an EPC, or a Home Report (Scotland only) is held for this property, it is available for inspection at the branch by appointment. If you require a printed version of a Home Report, you will need to pay a reasonable production charge reflecting printing and other costs. 6. We are not able to offer an opinion either written or verbal on the content of these reports and this must be obtained from your legal representative. 7. Whilst we take care in preparing these reports, a buyer should ensure that his/her legal representative confirms as soon as possible all matters relating to title including the extent and boundaries of the property and other important matters before exchange of contracts.

William H Brown is a trading name of Sequence (UK) Limited which is registered in England and Wales under company number 4268443, Registered Office is Cumbria House, 16-20 Hockliffe Street, Leighton Buzzard, Bedfordshire, LU7 1GN. VAT Registration Number is 500 2481 05.



**william h brown**



**01379 644719**



[Diss@williamhbrown.co.uk](mailto:Diss@williamhbrown.co.uk)



1 Navire House Mere Street, DISS, Norfolk,  
IP22 4AG



**[williamhbrown.co.uk](http://williamhbrown.co.uk)**