

Devonport Street, E1

£1,850 Per calendar month

A modern one bedroom apartment based in the popular Arta House Building. This property offers a large open plan living kitchen room, a large private balcony with nice views of the City and lots of built in storage areas. An ideal property for a single professional or a couple looking to be close to the City.

Arta House is located under half a mile from Limehouse Station and over half a mile from Shadwell Stations.

Features

- One Double Bedroom
- Open Plan Living Room
- Furnished
- Bike Storage
- Private Balcony
- Lift Access
- Day Time Concierge

Devonport Street, London, E1

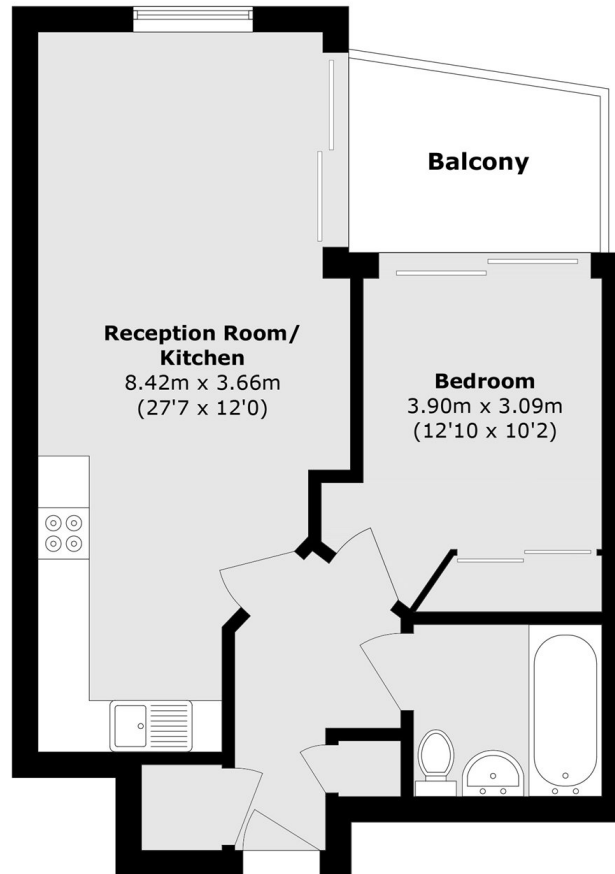

Total area (approx.): 50.2 sq. m (540.4 sq. ft)

Balcony area (approx.): 6.0 sq. m (64.6 sq. ft)