



Hadfield Road, North Walsham NR28 0BE

welcome to

Hadfield Road, North Walsham

****GUIDE PRICE £210,000 - £220,000**** This stylish and well-presented two-bedroom semi-detached home in a quiet North Walsham location is perfect for first-time buyers, downsizers, or investors. Offering a modern kitchen, bright lounge, two bedrooms, bathroom and an enclosed wrap-around garden.



This immaculately presented two bedroom semi-detached home set back from the road in a cul-de-sac location in North Walsham would make an ideal first time buyer home or investment purchase within close proximity to the town centre, amenities, schools and park. The property offers accommodation comprising entrance porch, entrance hall, lounge and kitchen on the ground floor. The first floor boasts two bedrooms and a family bathroom. Externally you will find a larger than average wrap-around, enclosed garden and two allocated parking spaces. Viewing is essential to fully appreciate this property.

Entrance Porch

Double-glazed door to front aspect.

Entrance Hall

Stairs to the first floor with low level lighting, door to the front aspect and access into lounge,

Lounge/Diner

Double-glazed window to front aspect, TV point, radiator, decorative panelled walls, wall lights and carpeted flooring.

Kitchen

Fitted kitchen with a range of wall and base units with work surfaces over, breakfast bar, extractor fan, one and a half sized stainless steel sink and drainer, space for fridge/freezer, radiator, plumbing for washing machine, tiled splash back, electric oven and hob, double-glazed window to rear aspect, double-glazed door to rear aspect and laminate flooring.

First Floor Landing

Airing cupboard with gas central heating boiler, access into loft space and carpeted flooring.

Bedroom One

Double-glazed window to front aspect, built in wardrobes, TV point, radiator and carpeted flooring.

Bedroom Two

Double-glazed window to rear aspect, radiator and carpeted flooring.

Bathroom

Suite comprising bath with mixer tap and electric shower over, wash hand basin, WC, radiator, vinyl flooring, part tiled walls and a double-glazed window to the rear aspect.

Parking

Allocated parking for two vehicles at the front of the property, set back from the road.

Garden

The garden is wrap-around and larger than average. The front offers side gate access to the rear, lawn area and pathway to the front door. The rear garden is mainly laid to lawn with decking area, garden shed and bordering flower beds.

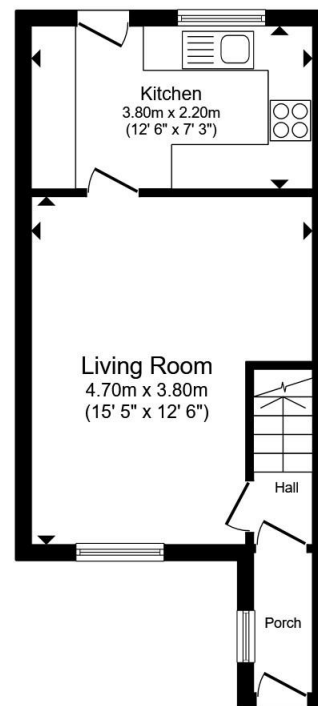

Ground Floor

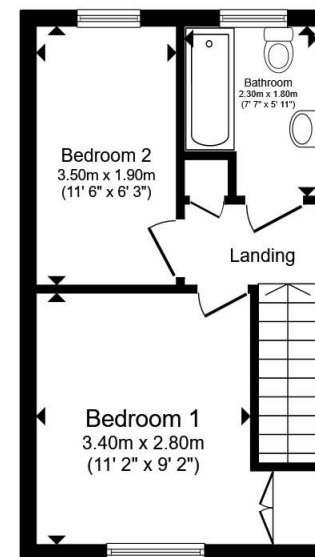

First Floor

Total floor area 54.8 m² (590 sq.ft.) approx

This floor plan is for illustrative purposes only. It is not drawn to scale. Any measurements, floor areas (including any total floor area), openings and orientation are approximate. No details are guaranteed, they cannot be relied upon for any purpose and they do not form part of any agreement. No liability is taken for any error, omission or misstatement. A party must rely upon its own inspection(s). Powered by www.propertybox.io



view this property online williambrown.co.uk/Property/NWM110092



welcome to

Hadfield Road, North Walsham

- Immaculately Presented Home
- Semi-Detached House
- Ideal for First Time Buyers or Investors
- Two Allocated Parking Spaces
- Larger Than Average Plot
- Close Proximity to Schools, Park and Amenities
- Opportunity to Extend (STPP)

Tenure: Freehold EPC Rating: D

Council Tax Band: A

guide price

£210,000



Please note the marker reflects the postcode not the actual property

view this property online williamhbrown.co.uk/Property/NWM110092



Property Ref:
NWM110092 - 0005

1. MONEY LAUNDERING REGULATIONS Intending purchasers will be asked to produce identification documentation at a later stage and we would ask for your co-operation in order that there is no delay in agreeing the sale. 2. These particulars do not constitute part or all of an offer or contract. 3. The measurements indicated are supplied for guidance only and as such must be considered incorrect. Potential buyers are advised to recheck measurements before committing to any expense. 4. We have not tested any apparatus, equipment, fixtures or services and it is in the buyers interest to check the working condition of any appliances. 5. Where an EPC, or a Home Report (Scotland only) is held for this property, it is available for inspection at the branch by appointment. If you require a printed version of a Home Report, you will need to pay a reasonable production charge reflecting printing and other costs. 6. We are not able to offer an opinion either written or verbal on the content of these reports and this must be obtained from your legal representative. 7. Whilst we take care in preparing these reports, a buyer should ensure that his/her legal representative confirms as soon as possible all matters relating to title including the extent and boundaries of the property and other important matters before exchange of contracts.

William H Brown is a trading name of Sequence (UK) Limited which is registered in England and Wales under company number 4268443, Registered Office is Cumbria House, 16-20 Hockliffe Street, Leighton Buzzard, Bedfordshire, LU7 1GN. VAT Registration Number is 500 2481 05.

william h brown



01692 402861



NorthWalsham@williamhbrown.co.uk



16 Market Street, NORTH WALSHAM, Norfolk,
NR28 9BZ



williamhbrown.co.uk