



Coopers

Coopers

Mayfield Road, Earlsdon, Coventry CV5 6PL

Price: £269,500



Mayfield Road

Earlsdon, Coventry

Bay-fronted terrace with real potential - two reception rooms - three good bedrooms - scope to improve and add value - well placed for the Earlsdon, the city centre and road links
Council Tax band: B

Tenure: Freehold

EPC Energy Efficiency Rating: D

- Bay-fronted mid-terrace in the heart of Earlsdon
- Two separate reception rooms offering flexible living space
- Three well-proportioned bedrooms off the landing
- Ground floor shower room plus first floor bathroom
- Kitchen to the rear with scope to reconfigure
- Ideal for first-time buyers or investors
- Opportunity to modernise and add value
- Rear garden with patio and established planting
- Walking distance to Earlsdon high street and good access to the city centre and A45





Coopers



Coopers



Coopers

Ground Floor

Approx. 52.9 sq. metres (569.7 sq. feet)

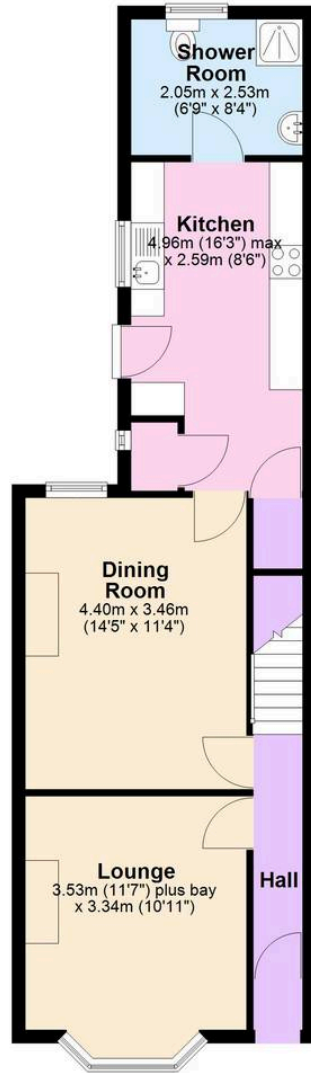

First Floor

Approx. 49.9 sq. metres (537.1 sq. feet)

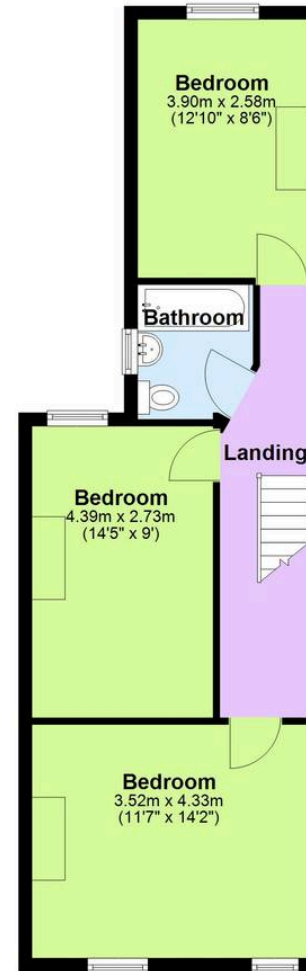

*Floor plan measurements are approximate and are for illustrative purposes only. While every effort is made to ensure accuracy, no responsibility is taken for any error, omission, or misstatement. Do not scale from this plan.
Plan produced using PlanUp.□□

Coopers Estate Agents

Coopers, 22 New Union Street - CV1 2HN



024 7655 2841 • sales@coopersstateagents.com • www.coopersstateagents.com/

Coopers Chartered Surveyors Ltd, 22 New Union Street, Coventry, West Midlands

CV1 2HN, 024 7655 2841, sales@coopers-cov.com. Company Registration

Number: 6725089 / VAT number: 940 3555 34