

# LIVERMORES

THE ESTATE AGENTS

2 Bedrooms

Apartment

By Auction

£140,000

Located in

Dartford



[www.livermores.co.uk](http://www.livermores.co.uk)

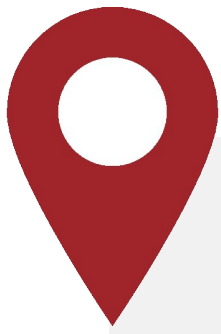

# 66A High Street

Dartford DA1 1DE



GUIDE PRICE £140,000 TO £150,000...

TO BE SOLD BY PUBLIC AUCTION THURSDAY 07 MAY 2026.

Acting as joint auctioneer with Clive Emson Auctioneers we are delighted to offer this property to the market.

The dates for the viewings are:

25th April 10am – 10.30am.

27th April 5pm – 5.30pm

30th April 5pm – 5.30pm.

Contact us to book your your viewing appointment.



# 66A High Street

£140,000 Leasehold



- GUIDE PRICE £140,000 - £150,000
- TO BE SOLD BY PUBLIC AUCTION  
THURSDAY 07 MAY 2026
- SPLIT LEVEL APARTMENT
- CHAIN FREE
- GREAT LOCATION FOR DARTFORD TOWN  
CENTRE & STATION
- 102 YEAR LEASE
- 850 SQUARE FEET
- TWO RECEPTION ROOMS
- SIMILAR PROPERTIES REQUIRED
- COUNCIL TAX BAND 'C', EPC RATING 'D'



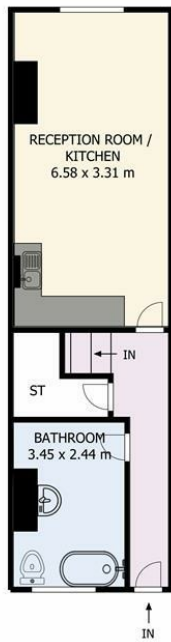

Ground Floor



First Floor

High St Dartford DA1 1DE

This plan serves solely as a layout guide, and no liability is assumed for errors, omissions, or inaccuracies. It was developed in accordance with the RICS Code of Measuring Practice. All dimensions, including windows, doors, and the Total Gross Internal Area (GIA), are estimated and measured internally. For accurate measurement please consult a certified architect or surveyor prior to making any decisions based on this plan. The first measurement provided refers to the vertical wall.

## Council Tax Band C

## Local Authority DARTFORD

Agents Note: Whilst every care has been taken to prepare these particulars, they are for guidance purposes only. All measurements are approximate and are for general guidance purposes only and whilst every care has been taken to ensure their accuracy, they should not be relied upon and potential buyers/tenants are advised to recheck the measurements.

Energy Efficiency Rating		
	Current	Potential
Very energy efficient - lower running costs		
(92 plus) <b>A</b>		
(81-91) <b>B</b>		
(69-80) <b>C</b>		
(55-68) <b>D</b>	64	67
(39-54) <b>E</b>		
(21-38) <b>F</b>		
(1-20) <b>G</b>		
Not energy efficient - higher running costs		
<b>England &amp; Wales</b>	EU Directive 2002/91/EC	

1 Hythe Street  
Dartford  
Kent  
DA1 1BE



dartford@livermores.co.uk

01322 228090

www.livermores.co.uk