

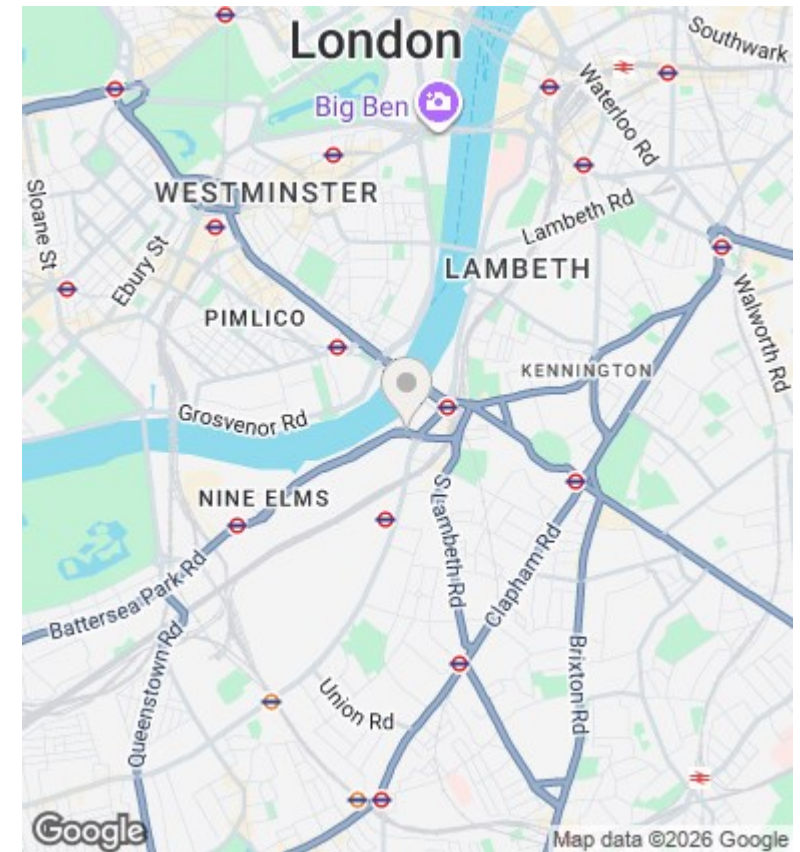

## The Tower, St. George Wharf, Vauxhall, London SW8 2DU

£1,750,000

- 24/7 CONCIERGE
- SMART HOME SYSTEM
- RESIDENCE LOUNGE
- REFURBISHED
- VIDEO VIEWING AVAILABLE
- RESIDENCE GYM / SPA AND SWIMMING POOL OVERLOOKING RIVER
- UNDERGROUND PARKING
- 3 BEDROOMS 2 BATHROOMS
- CINEMA
- MOMENTS AWAY FROM VAUXHALL STATION

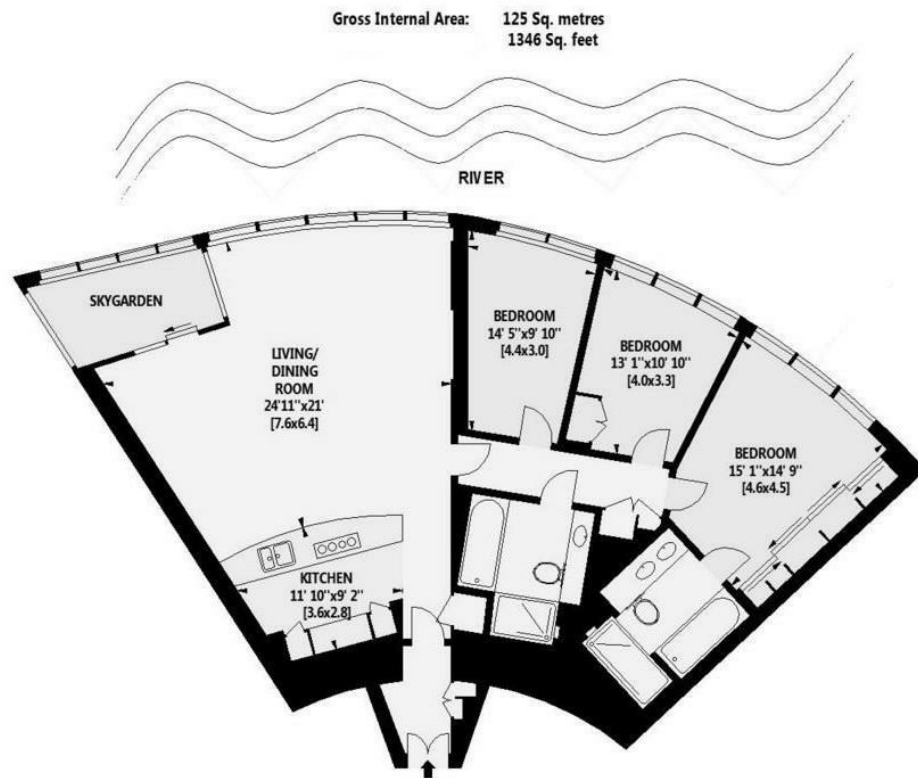

## Viewings

Viewings by arrangement only.  
Call 02077225022 to make an appointment.

## Council Tax Band

B

## EPC Rating:

B

Energy Efficiency Rating		Current	Potential
<i>Very energy efficient - lower running costs</i>			
(92 plus)	A		
(81-91)	B	85	85
(69-80)	C		
(55-68)	D		
(39-54)	E		
(21-38)	F		
(1-20)	G		
<i>Not energy efficient - higher running costs</i>			
<b>England &amp; Wales</b>		EU Directive 2002/91/EC	