

## 15 Cherry Close, Prestatyn, Denbighshire LL19 7DQ

£210,000

🛏 2 🚿 1 🚗 2



**NO FORWARD CHAIN** - This detached two bedroom bungalow occupies a corner position and offers a good size lounge with the addition of a sun lounge, two bedrooms, fitted kitchen, utility porch, shower room and cloakroom. Having a driveway and Garage with good size gardens and an enclosed rear patio.

**DIRECTIONS** From the Prestatyn office turn onto Fforddisa and continue to the crossroads turning right onto Ffordd Penrhwylyfa, proceed over the mini roundabout and railway bridge, turn left onto Lon Dyfi, left onto Marion Road and proceed to the far end onto Garnett Drive and left onto Cherry Close, the property will be seen on the right hand side.

## Key Features

- DETACHED TWO BED BUNGLAOW
- LEVEL CORNER POSTION
- ESTABLISHED GARDENS
- ENCLOSED REAR PATIO WITH STORE
- DRIVEWAY & GARAGE
- SPACIOUS LOUNGE
- ADDITONAL SUN LOUNGE
- SHOWER ROOM & CLOAKROOM
- FREEHOLD
- COUNCIL TAX - C EPC - tbc

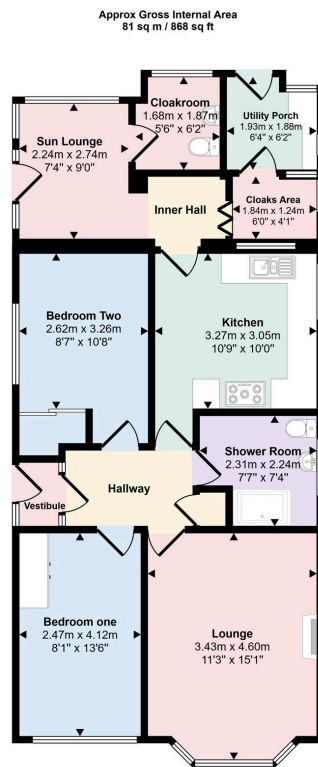

Floorplan

This floorplan is only for illustrative purposes and is not to scale. Measurements of rooms, doors, windows, and any items are approximate and no responsibility is taken for any error, omission or mis-statement. Icons of items such as bathroom suites are representations only and may not look like the real items. Made with Made Snappy 360.

### CONSUMER PROTECTION REGULATIONS 2008 AND THE BUSINESS PROTECTION FROM MISLEADING MARKETING REGULATIONS 2008

These particulars, whilst believed to be accurate, are set out for guidance only and do not constitute any part of an offer or contract. Prospective purchasers or tenants should not rely on these particulars as statement or representation of fact, but must satisfy themselves by inspection or otherwise as to their accuracy. No person in the employment of PETER LARGE Estate Agents has the authority to make or give any representation or warranty in relation to the property. Room sizes are approximate and all comments are of the opinion of PETER LARGE Estate agents having carried out a walk through inspection. These sales particulars are prepared under the consumer regulations 2008 and are governed by the business from misleading marketing regulations 2008.