



SPENCERS
LETTINGS



8 Richmond Court Spencer Road
New Milton

£1,300 PCM

Situated in Richmond Court on Spencer Road, this generously sized, three bedroom first-floor flat offers comfortable living in a well-maintained block close to local amenities with access to a garage. The property has recently been repainted throughout. Holding deposit: £288 Security deposit: £1442 Council tax band: D



- Central location • First floor • Garage in block • Available long term • Communal stairs • Balcony

The kitchen features ample worktop and cupboard space, washing machine and an integrated oven and hob. The living room itself is a great size, enhanced by a feature fireplace and sliding doors that open onto a private balcony overlooking the front of the block.

The accommodation comprises three bedrooms, including a spacious master with built-in wardrobes. The bathroom has shower over the bath, hand basin and toilet.

Additional benefits include a garage located in a nearby block, providing secure parking or extra storage.

This property presents a fantastic opportunity for those seeking a spacious home in a central location.

The property's construction is brick and tile.

The property has mains gas central heating, an electricity supply, mains water and mains drainage.

The broadband and mobile availability can be checked via the Ofcom's "broadband and mobile coverage checker" on their website.

ADDITIONAL INFORMATION

Council Tax Band: D

Furnishing Type: Unfurnished

Security Deposit: £1,500

Available From: 24th April 2026



FLOOR PLAN

Ground Floor

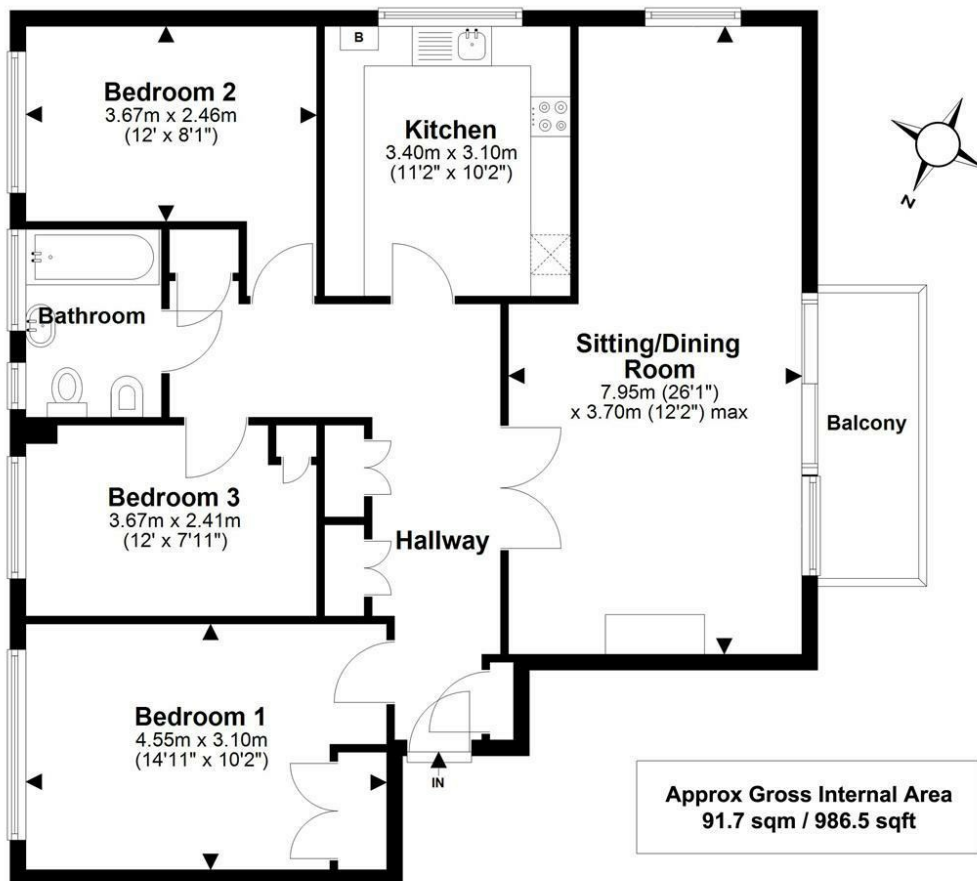

Illustration for identification purposes only; measurements are approximate, not to scale. www.fpusketch.co.uk
Plan produced using PlanUp.



Energy Efficiency Rating

	Current	Potential
Very energy efficient - lower running costs		
(92 plus) A		
(81-91) B		
(69-80) C	79	82
(55-68) D		
(39-54) E		
(21-38) F		
(1-20) G		
Not energy efficient - higher running costs		
England & Wales	EU Directive 2002/91/EC	



SPENCERS

LETTINGS

ABOUT US

As the leading independent letting agency in the New Forest and surrounding areas, Spencers offers tenants a friendly, reliable and highly knowledgeable service. With offices across the region, including Lymington, Highcliffe, Brockenhurst, Burley, Ringwood, and Romsey, our local teams are here to help you find the right home and support you throughout your tenancy.

Our lettings teams live and work within the Forest and its nearby towns. This means you benefit from genuine local insight from nearby schools and transport links to community life and coastal or countryside surroundings.

We work closely with our landlords and manage a wide range of homes across the Forest and surrounding towns. We have memberships with Safe Agent, the Property Ombudsmen, and the Tenancy Deposit Scheme (TDS) ensuring your tenancy is handled professionally, transparently and with your best interests in mind.

Please contact us on the below:

Lymington 01590 624814

Highcliffe 01425 205000

Romsey 01794 331433

lettings@spencersproperty.co.uk

www.spencersproperty.com

