



Rosebery Court

London, EC1R

Asking Price £595,000

Set on the first floor of Rosebery Court, this well-planned apartment offers a bright, dual-aspect reception room flooded with natural light and access to an attractive balcony — an enviable feature for city living. The accommodation is arranged over one floor and comprises two generously sized double bedrooms, a bathroom, a spacious reception room, and a functional kitchen.

Presented in excellent decorative order throughout, the property is immediately habitable. Residents of Rosebery Court benefit from a passenger lift, a secure entry system, and access to a delightful landscaped communal garden — a rare and welcome sanctuary in the heart of the city.

CHESTERTONS



Rosebery Court

London, EC1R

- Two Double Bedrooms
- Lift
- Balcony
- Communal Garden
- Secure Entry System
- Close To Transport Links & Amenities



Ideally suited to City professionals, first-time buyers, or investors seeking a stylish and practical London base, this apartment also lends itself perfectly as a pied-à-terre. The development is entirely privately owned, offering a cohesive and well-managed environment.

With Exmouth Market just 0.2 miles away, the apartment places one of London's finest street-food and independent dining destinations at your doorstep. The legendary jewellery quarter of Hatton Garden lies 0.3 miles distant, whilst the broader neighbourhood offers an abundance of cafés, cultural venues, and green spaces.

Tenure: Leasehold 112 years
Service Charge: £6,000 per year
Ground Rent: £50 per year
Local Authority: Islington Council
Council Tax Band: E

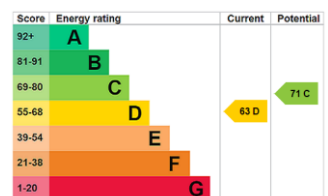

Chestertons Covent Garden Sales

196 Shaftesbury Avenue
 London
 WC2H 8JF
 coventgarden@chestertons.co.uk
 020 3040 8300
 chestertons.co.uk

Rosebery Court, Rosebery Avenue

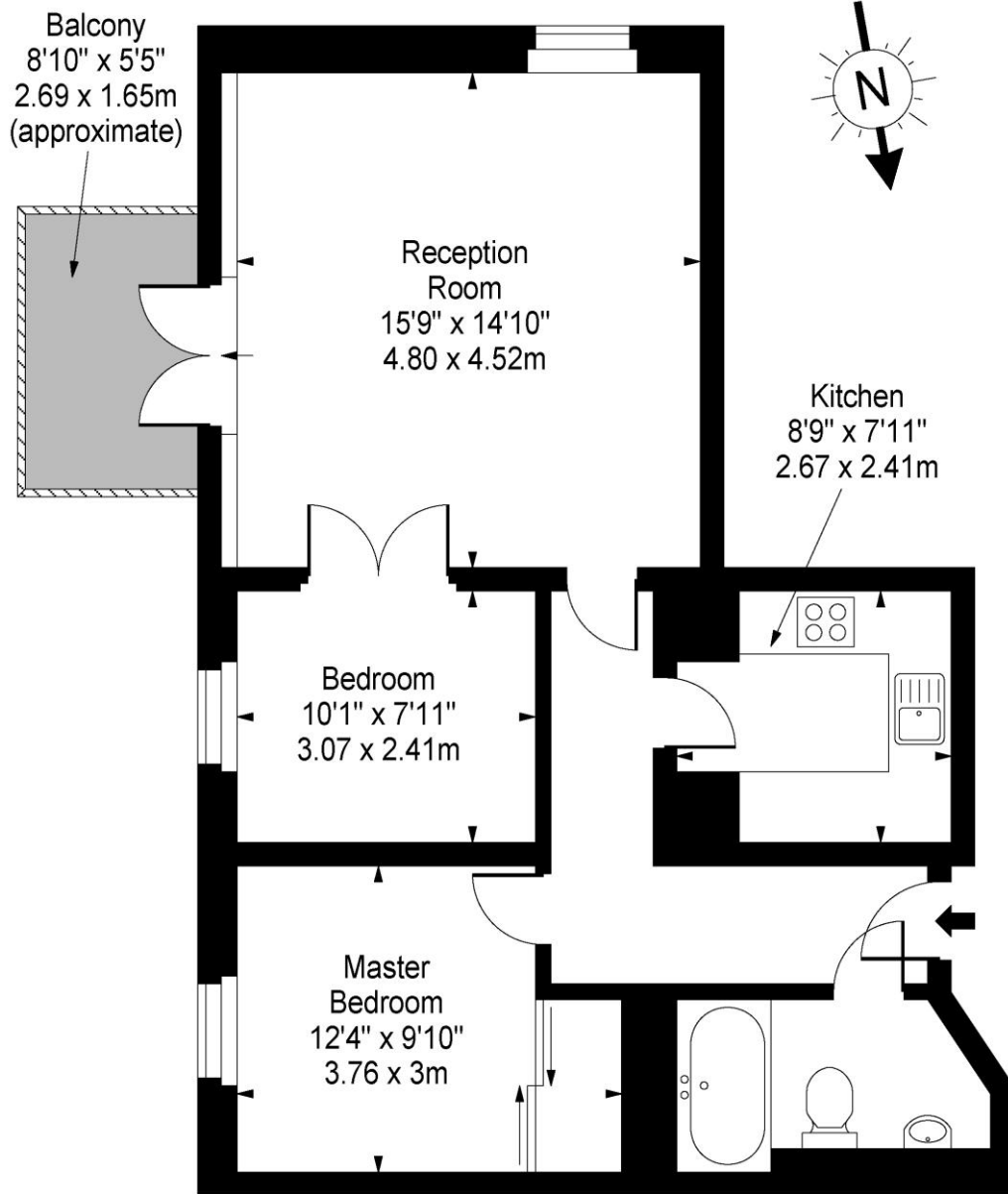

First Floor

Approx Gross Internal Area **668 Sq Ft - 62.05 Sq M**

For Illustration Purposes Only - Not To Scale

www.goldlens.co.uk

Ref. No. 003868A

