



38

39

enfields

Enfields Home  
1116 Mill Lane  
Merton, London SW19 9JL  
Tel: 020 888 8510  
www.enfields.co.uk

# Ivy Dene, Southampton, SO19 0AD

Guide Price £250,000

🛏️ 2 🪑 1 🚗 1



- Two Double Bedrooms
- Open Planned
- Allocated Parking Space
- Viewing Highly Recommended
- Terraced House
- Private Rear Garden
- Well Presented Throughout
- Ideal First Time Buy





Enfields are pleased to present this beautifully presented two-double-bedroom terraced house, offering an open-plan layout, allocated parking, and a private rear garden – an ideal opportunity for a first-time purchase.

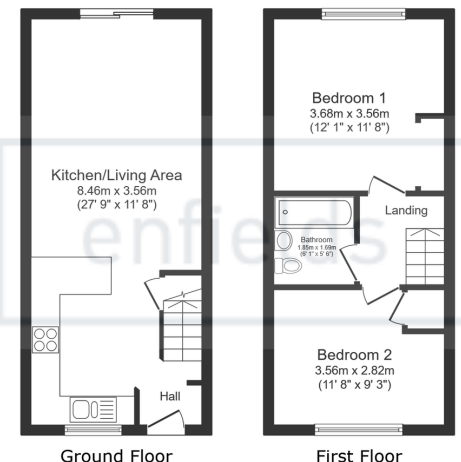

Total floor area: 60.1 sq.m. (647 sq.ft.)

This floor plan is for illustrative purposes only. It is not drawn to scale. Any measurements, floor areas (including any total floor area), openings and orientations are approximate. No details are guaranteed, they cannot be relied upon for any purpose and do not form any part of any agreement. No liability is taken for any error, omission or misstatement. A party must rely upon its own inspection(s). Powered by www.Propertybox.io

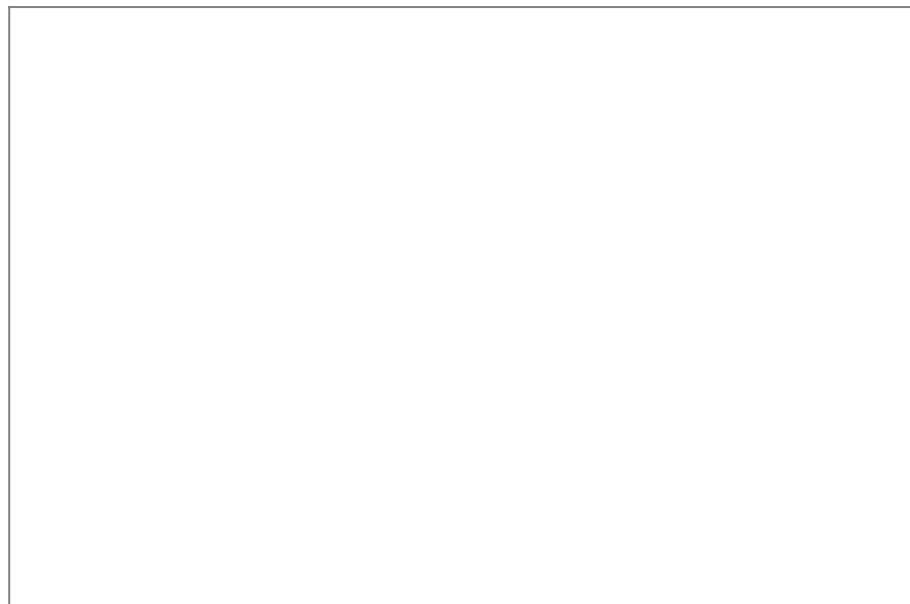

[www.enfields-southampton.co.uk](http://www.enfields-southampton.co.uk)



It is Enfields policy to respect any sole agency currently in force and we would not be able to commence marketing until this has expired or been terminated. If you fail to terminate any previous agreement you could be liable for two sets of fees. Enfields Hythe is a trading name of YTF LTD Registered office: 345 Shirley Road, Southampton, Hampshire, England, SO15 3JD. Company Registration No: 10459987. VAT Registration No: 281 2975 81.

Enfields Lettings - Embley Management LTD T/A Enfields. Registered Address: 345 Shirley Road, Southampton, Hampshire, England, SO15 3JD. Company Registration No: 14847604. VAT Registration No: 439 8546 45.