



Lancaster Street, SE1

£485,000

A very spacious 837 sq ft, west-facing flat, with three double bedrooms, a spacious living room, leading out onto a private balcony and overlooking the communal gardens, a large kitchen-diner, family bathroom and WC.

Lancaster Street is incredibly well located, tucked back off Blackfriars Road, moments from Southwark, Waterloo and Blackfriars Stations, with the Cut, Lower Marsh and the South Bank all on your doorstep.

Features

- West-Facing
- Three Double Bedrooms
- Large Kitchen-Diner
- Separate Living Room
- Private Balcony
- Very Central Location

Lancaster Street, London, SE1

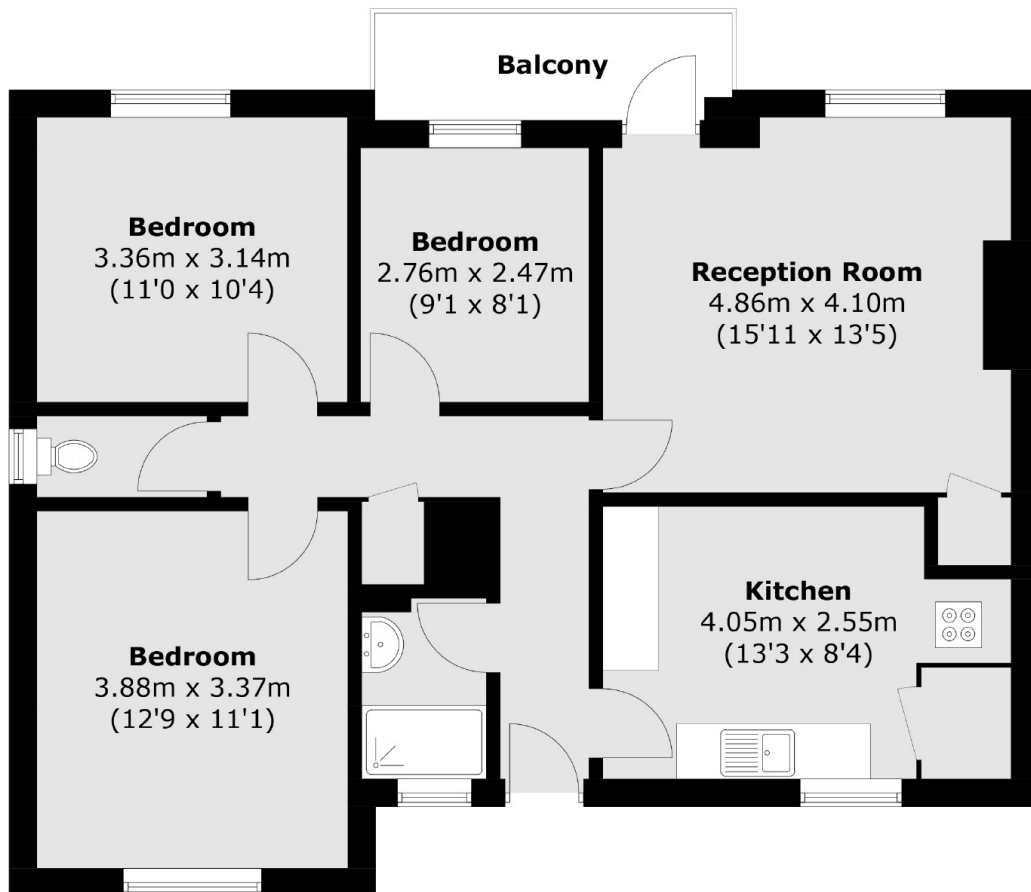

Total area (approx.): 77.8 sq. m (837.4 sq. ft)
Balcony: 4.5 sq. m (48.4 sq. ft)

Dexters

London Bridge
54 Borough High Street
London
SE1 1XL
Sales
020 7650 5 100

Energy Rating: C. We aim to make our particulars both accurate and reliable. However they are not guaranteed; nor do they form part of an offer or contract. If you require clarification on any points then please contact us, especially if you're traveling some distance to view. Please note that appliances and heating systems have not been tested and therefore no warranties can be given as to their good working order.

 **RICS** | Regulated
Estate Agent
and Letting Agent

[dexters.co.uk](https://www.dexters.co.uk)