



16a - Welbeck Road



# 16a - Welbeck Road Canvey Island SS8 0EB

£300,000



Located in this sought-after location and within easy reach of the town centre and the seafront is this larger than average and well presented Two-Bedroom Detached Bungalow.

The accommodation includes a UPVC double-glazed entrance door leading to the porch, which connects to an elegant lounge with a feature wood burner. From here is a good-sized modern fitted kitchen with an array of appliances, which are to remain. To the rear of the property are two well-proportioned bedrooms, and completing the accommodation is the modern fitted bathroom.

The property benefits from gas-fired central heating, UPVC double-glazed windows, off-street parking to the front and a garden to the rear, which is fairly unoverlooked with a decking area.

No Onward Chain



## Porch

UPVC double-glazed entrance door into a porch area with a further double-glazed door connecting to the rear garden, although there is a shed blocking this access, part glazed door connecting directly into the lounge.

## Lounge

52'5"6" x 39'4"32"9" (16'2 x 12'10)

A larger than average elegant lounge with a large double-glazed window to the front elevation, radiator, laminate wood-style flooring, a feature

wood burner to remain, a door to an inner hall, door connecting directly into the kitchen.

## Kitchen

16'3 x 8' (4.95m x 2.44m)

Double-glazed window to the front elevation, double-glazed door opening onto the garden at the rear, and wood-style laminate flooring. A modern fitted kitchen fitted with an extensive range of cream units and drawers at base level, wood-style work surfaces over with an inset circular stainless steel sink with drainer area and chrome mixer

taps, matching work surface splashback areas, breakfast bar, integral dishwasher, plumbing and space for washing machine and fridge/freezer, stainless steel extractor unit with range style cooker below to remain, matching units at eye-level plus radiator, flat plastered ceiling with inset spotlights.

### Inner Hall

Doors connecting to the bedrooms and the modern bathroom.

### Bedroom One

12' x 9' (3.66m x 2.74m)

Double-glazed window to the rear elevation with radiator, wood-style laminate flooring, and a cupboard housing the boiler.

### Bedroom Two

10'10" x 7'4" (3.30m x 2.24m)

A good-sized second bedroom for this style of property with double glazed window to the rear elevation, access to the loft, a radiator, and laminate flooring.

### Bathroom

A modern fitted bathroom with a panelled bath with a shower screen, low-level w/c, vanity unit with inset wash hand basin, double-glazed window to the side elevation, fully tiled to the walls in ceramics, chrome heated towel rail.

### Exterior

#### Front Garden

Off-street parking to the front with a shingled area and pathway connecting to the front door.

#### Rear Garden

Fairly secluded with a large decked area, with the remainder being mainly laid to lawn, fenced to the boundaries, and a shed to remain.

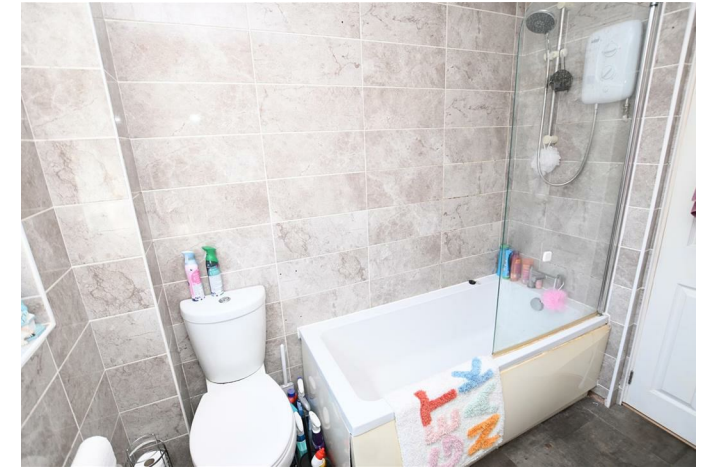

## Ground Floor

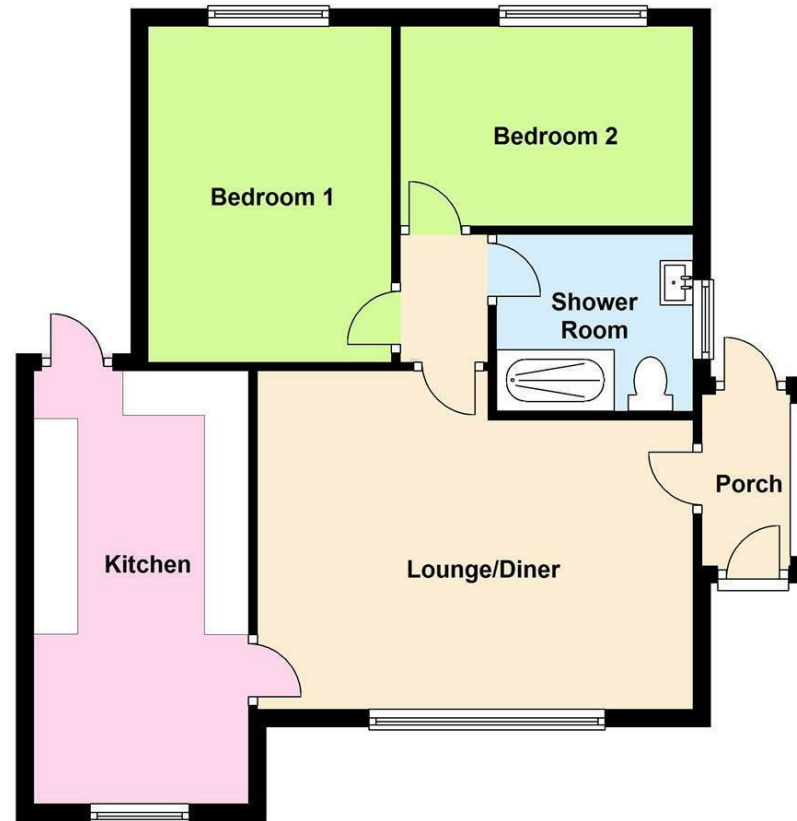

**Misrepresentation Act 1967:** These details are prepared as a general guide only, and should not be relied upon as a basis to enter a legal contract or commit expenditure. And any interested party should rely solely on their own Surveyor, Solicitor/Conveyancer or other professionals before committing themselves to any expenditure or other legal commitments. If any interested party wishes to rely upon any information from the Agent, then a request should be made and specific written confirmation can be provided. The Agent will not be responsible for any verbal statement made by the Agent or any member of Staff, as only a specific written confirmation can be provided. The Agent will not be responsible for any loss other than what specific written confirmation has been requested.

**Property Misdescription Act 1991** The Agent has not tested any apparatus, equipment, fixture, fittings or services and so does not verify they are in working order, fit for purpose, or within ownership of the sellers, therefore the buyer must assume the information is incorrect. Neither has the Agent checked the legal documentation to verify legal status of the property. A buyer must assume the information is incorrect until it has been verified by their own Solicitors/Conveyancers. Nothing concerning the type of construction or the condition of the structure is to be implied from the photograph or plans for the property. Photographs of the interior of the property are given purely to give an indication of décor/style etc. and does not imply that any furniture/fittings etc., are included. A fixtures & fittings list will be provided by the Solicitors/Conveyancers in due course. The sales particulars may change in the course of time and any interested party is advised to make a final inspection of the property prior to exchange of contracts



**Tel No: 01268 699 599 | Fax: 01268 699 080 | Email: [rp@richardpoyntz.com](mailto:rp@richardpoyntz.com)**  
**Registered Office: Richard Poyntz & Company, 11 Knightswick Road, Canvey Island SS8 9PA**

Partners: Richard P. Poyntz F.N.A.E.A., James R. Poyntz M.N.A.E.A., Anna L. Poyntz & Sara Poyntz • V.A.T No: 731 4287 45  
Richard Poyntz & Co (Partnership) is an introducer appointed representative of Stonebridge Mortgage Solutions Ltd for mortgage and insurance introductions.  
Stonebridge Mortgage Solutions Ltd is authorised and regulated by the Financial Conduct Authority.

