



Abercorn Place

St John's Wood, NW8

£1,850 per month
(£426.92 per week)

A modern studio apartment in a secure purpose built mansion block, with day porter and heating/hot water being included in the rent.

CHESTERTONS



Abercorn Place

St John's Wood, NW8

- Second Floor Flat
- Studio, Wood Floor, Large Bathroom
- Lift, Porter, Good Transport Links
- Heating and Hot Water included in the rent



A modern studio apartment in a secure purpose built mansion block, with day porter and within very close proximity to both Maida Vale (Bakerloo Line) and St John's Wood (Jubilee Line) Stations.

The property comprises spacious studio room with fitted kitchen and large bathroom with full sized bath. Additionally the kitchen has a dishwasher and washing machine.

The property further benefits from lift access to all floor, heating and hot water included in the rent, and industrial sized washer/dryers in the basement for residents to use with contactless payments.

Minimum Term: 12 months
Deposit Required: £2,134.62
Local Authority: City Of Westminster
Council Tax Band: A
EPC Rating: D
Furnished

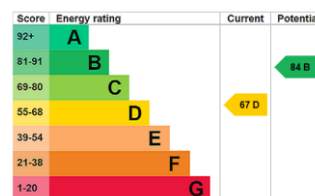

Chestertons St John's Wood Lettings

105 St. John's Wood Terrace
 London
 NW8 6PL
stjohnslettingsusers@chestertons.co.uk
 02030408622
chestertons.co.uk

Additional tenant charges apply (fees apply to non-AST tenancies only)
 Tenancy Agreement Fee: £300
 References per Tenant/Guarantor: £60
 Inventory check (approx. £100 – £250 inc. VAT)
chestertons.co.uk/property-to-rent/applicable-fees

Abercorn Place, NW8 9DU

Approx Gross Internal Area = 22.5 sq m / 242 sq ft

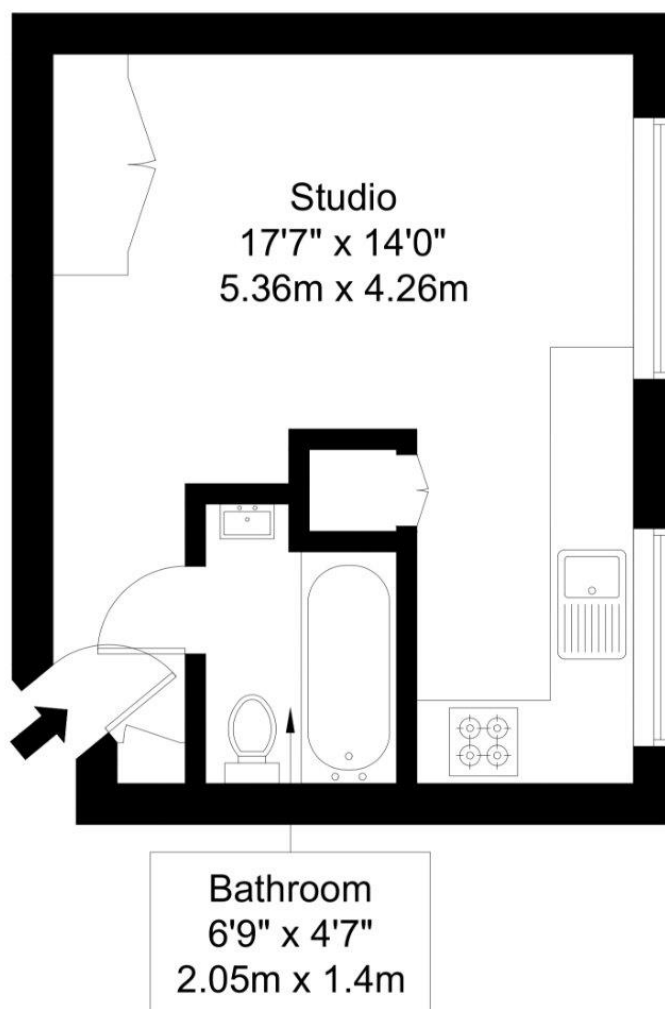
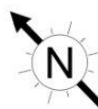

Second Floor

Ref :

Copyright

**B L E U
P L A N**

The Floor plan is not to scale and measurements and areas shown are approximate and therefore should be used for illustrative purposes only. The plan has been prepared in accordance with the RICS code of Measuring Practice and whilst we have confidence in the information produced it must not be relied on. Maximum lengths and widths are represented on the floor plan. If there is any aspect of particular importance, you should carry out or commission your own inspection of the property.

Copyright @ BleuPlan

