



161 Millbank, Westminster  
London SW1P

GARTON JONES.COM



GARTON JONES  
LONDON



161 Millbank, Westminster  
London, SW1P

GARTON JONES.COM

49 Marsham Street Sales +44 (0) 20 7340 0480  
London westminster@gartonjones.com  
SW1P 3DP www.gartonjones.com

£795 Per Week

We are pleased to offer to rent this 1 bedroom apartment located on the 3rd floor (with lift) of Riverwalk, a stunning new development situated on the banks of the River Thames by Vauxhall Bridge in Westminster. This bright and spacious apartment further comprises of a bright reception room with floor to ceiling windows accessing a large private balcony, there is a smart Kitchen with Miele integrated appliances, double bedroom with fitted wardrobes and contemporary bathroom. Additionally there is comfort cooling, underfloor heating in the wet rooms and a fully integrated Crestron home automation and entertainment system. Residents of Riverwalk enjoy exclusive private facilities including a fitness suite overlooking the Thames and a 24 hour concierge. The development is well located for access to the renowned local landmarks which include the Houses of Parliament, Westminster Abbey and the Tate Britain Gallery. The local transport links of Pimlico and Victoria Station is nearby providing mainline UK services including the Gatwick Express as well as the underground services of Victoria and Pimlico. Garton Jones' Westminster office is located close by so are readily available for viewings. Please note that the landlord requests payments in advance only.

Minimum Term 8 Months  
Deposit 5 Weeks  
Council Tax Band F (London Borough of Westminster)  
EPC B (83)

- One Bedroom Apartment
- 3rd Floor (Lift)
- Open Plan Reception Room
- Kitchen with Miele Integrated Appliances
- Available Immediately
- Furnished
- 24 Hour Concierge
- Residents Gym
- Close To Selection Amenities
- Moments From Transport Links of Pimlico & Victoria

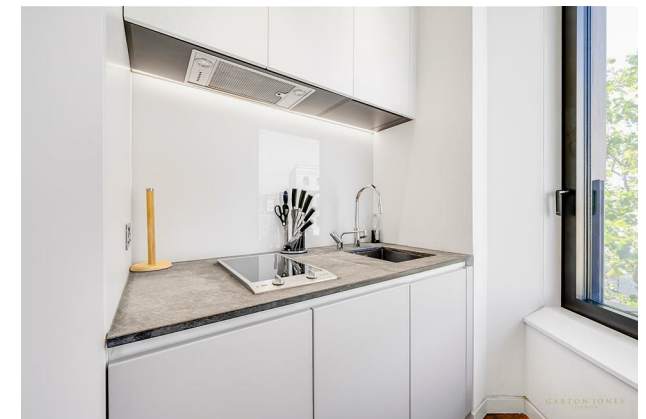

EPC certificate available on request.

## Riverwalk

Approximate Gross Internal Area = 485 sq ft / 45.1 sq m  
Balcony = 72 sq ft / 6.7 sq m

GARTON JONES  
LONDON

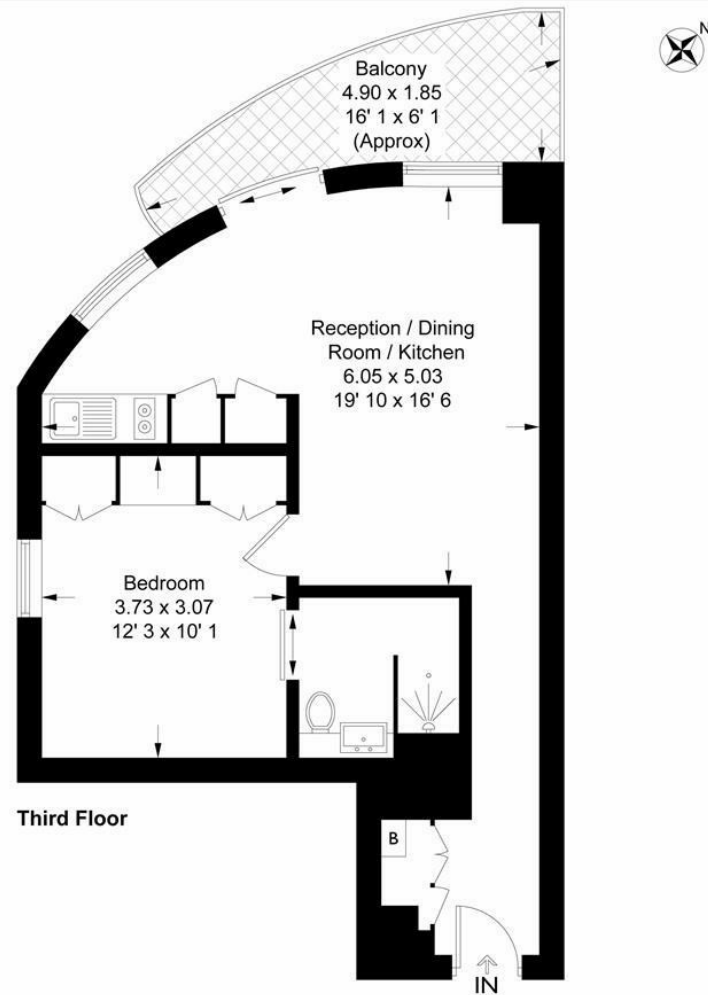

This plan is not to scale and must be used as layout guidance only. All measurements and areas are approximate and should not be relied upon to provide accurate information. This plan must not be relied upon when making property valuations, design considerations or any other such relevant decisions. We accept no responsibility or liability (whether in contract, tort or otherwise) in relation to any loss whatsoever arising from or in connection with any use of this plan or the adequacy, accuracy or completeness of it or any information within it.



