

Stroud Farm Road

Maidenhead • • SL6 2LH

Guide Price: £950,000



coopers
est 1986

Stroud Farm Road

M Maidenhead • • SL6 2LH

This spacious four bedroom detached family home with a two bedroom annexe and garage, situated in the charming sought after village of Holyport, conveniently close to the maidenhead town centre and Windsor.

Detached

Four double bedrooms

Separate two bedroom annexe with garage

Utility

Three large reception rooms

Downstairs shower room

Over 2000sq ft

Gated with driveway parking

Wide side access

Local amenities

These particulars are intended as a guide and must not be relied upon as statements of fact. Your attention is drawn to the Important Notice on the last page.





Property

The ground floor comprises a 22 sq m kitchen with integrated appliances, a separate utility room, a downstairs cloakroom, a boot room, a formal dining room, and a spacious reception room featuring a double sided log burner and bi-fold doors that open to the rear garden. On the first floor, there are four well-appointed bedrooms served by a four piece family bathroom.

Outside

The property includes a spacious gated driveway with direct access to a private backyard that offers a patio area and a large lawn. Additionally, there is a separate annex that provides its own entrance, two bedrooms and garage.

Location

In the village of Holyport, this property provides convenient access to Maidenhead train station (Elizabeth Line), Maidenhead Town Centre, and major motorway links.





Schools:

Holyport CofE Primary School 0.1 miles
Braywick Court School 1.1 miles



Train:

Maidenhead Station 1.9 miles
Taplow Station 2.5 miles
Furze Platt Station 3.0 miles



Car:

M4, A40, M25, M40



Council Tax Band:

E

(Distances are straight line measurements from centre of postcode)

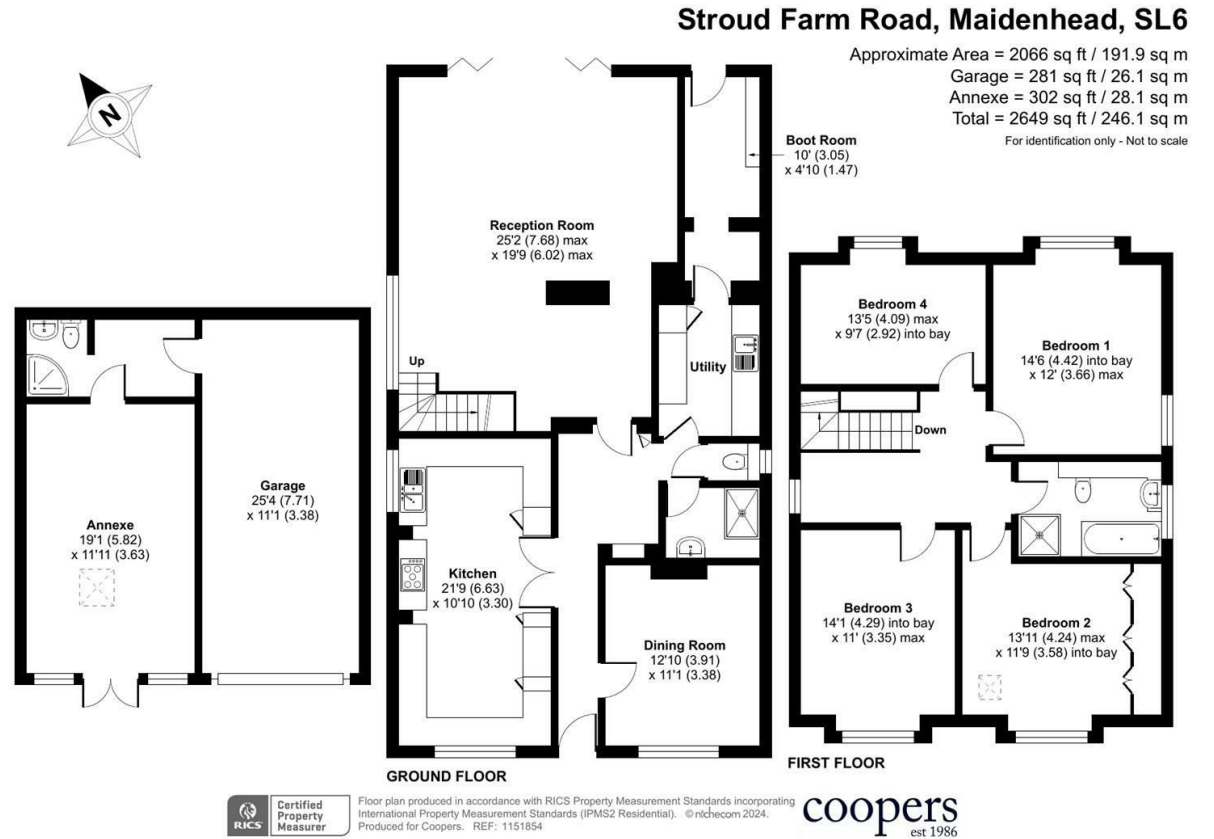
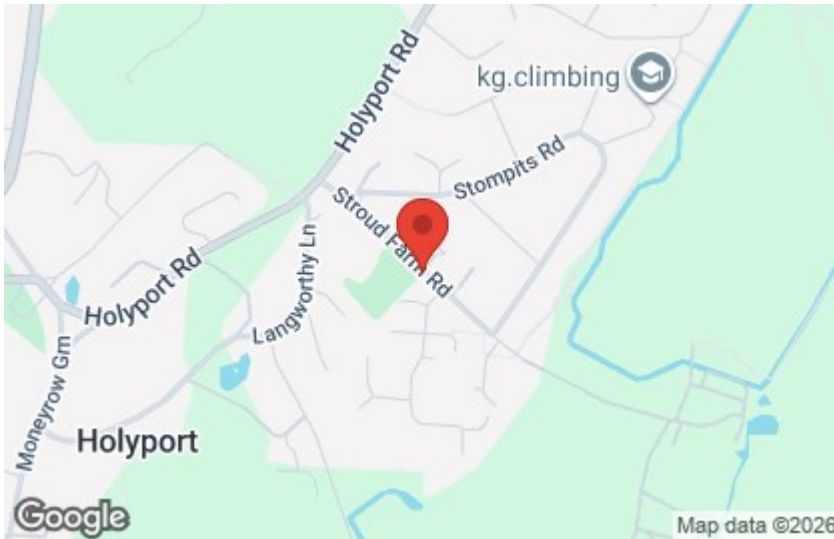

01628 232 550

42 Queen Street, Maidenhead,
, SL6 1HZ

maidenhead@coopersresidential.co.uk

CoopersResidential.co.uk

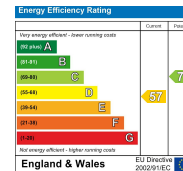

Important Notice: These particulars, whilst believed to be accurate are set out as a general outline only for guidance and do not constitute any part of an offer or contract. Intending purchasers should not rely on them as statements or representation of fact, but must satisfy themselves by inspection or otherwise has the authority to make or give any representation or warranty in respect of the property.