



## Campbell Road, E3

£2,000 Per calendar month

A large two double bedroom two bath apartment in Pryce House. This property is available furnished and has two equally sized double bedrooms, an open plan reception leading onto a private balcony.

Situated within a secure entry development nearby local amenities this apartment is also moments from Bow Road underground and Bow Church DLR stations.

### Features

- Two Double Bedrooms
- Two Bathrooms
- Open Plan
- Wooden Flooring
- Private Balcony
- Furnished

# Campbell Road, London, E3

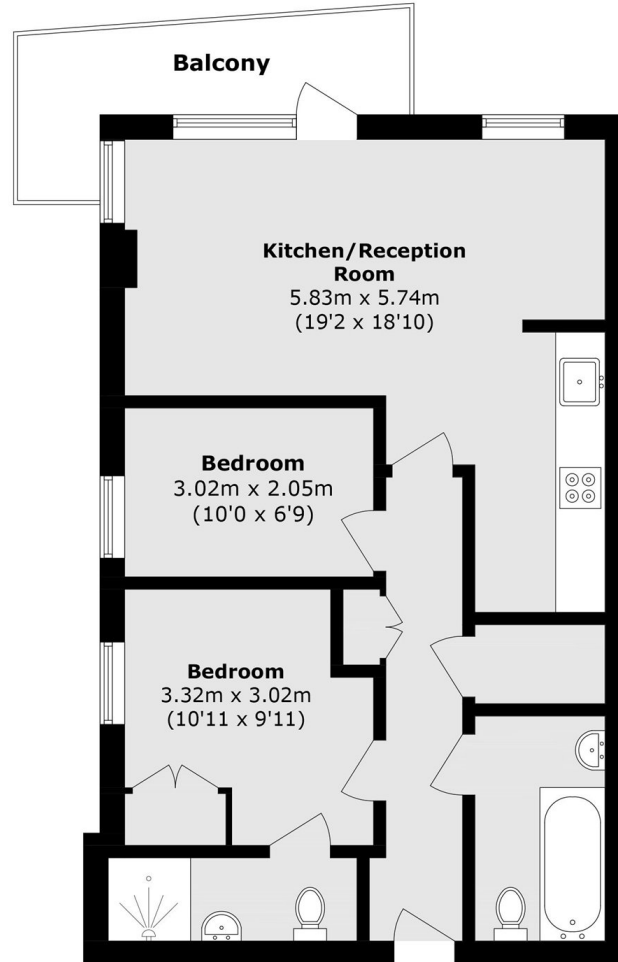

Total area (approx.): 56.9 sq. m (612.4 sq. ft)  
Balcony area (approx.): 6.4 sq. m (68.8 sq. ft)