



**POOLE  
TOWNSEND**



# Winfield Gardens, Allithwaite, Grange over Sands

£425,000

🛏 4 🚿 2 🛋 1





- Located in the picturesque village of Allithwaite.
- Bright and spacious lounge ideal for relaxing or entertaining.
- Master suite includes an en-suite bathroom for added privacy.
- Modern family bathroom designed for convenience.
- Council Tax Band E
- Beautiful four-bedroom home blending modern comfort with rural charm.
- Open-plan kitchen/diner with patio doors to a private garden.
- Three additional bedrooms suitable for family or home office use.
- Brick-set driveway and landscaped rear garden perfect for alfresco dining.
- Freehold





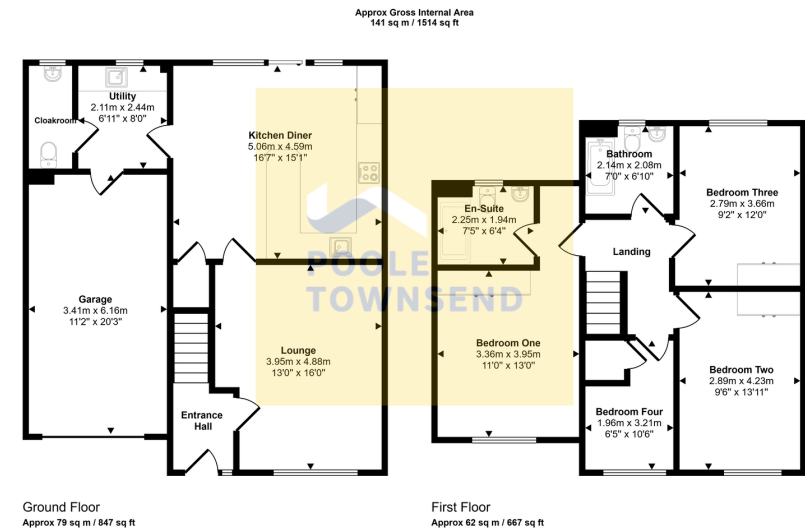

Nestled in the charming village of Allithwaite, this stunning four-bedroom home offers the perfect mix of modern living and rural tranquillity. The spacious lounge is flooded with natural light, creating a warm and inviting space for family time or entertaining. The heart of the home is the open-plan kitchen/diner, designed for easy family living and seamless indoor-outdoor entertaining, with patio doors leading to a private garden. Upstairs, the master suite provides a peaceful retreat with its own en-suite, while three additional bedrooms offer plenty of space for a growing family or home office. The family bathroom is fresh and modern, perfect for those busy mornings. To the front, a brick-set drive provides ample parking, while the rear garden with patio and mature borders offers a perfect spot for alfresco dining.

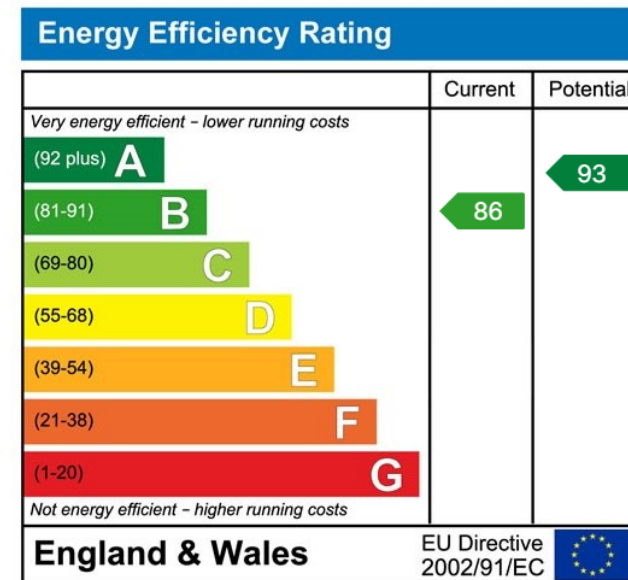

Visit us at  
[www.pooletownsend.co.uk](http://www.pooletownsend.co.uk)  
[enquiries@pooletownsend.co.uk](mailto:enquiries@pooletownsend.co.uk)

We are open  
 Monday – Friday 9.00 – 5.00  
 Saturday 9.00 – 1.00

Barrow 01229 811811  
 Ulverston 01229 588111  
 Grange 015395 33316  
 Kendal 01539 734455  
 Milnthorpe 015395 62044