



32 Violet Way

Kingsnorth Ashford, TN23 3GH

£1,300 Per Month

Two bedroom family home situated on the popular Bridgefield development in Kingsnorth. This property comprises modern fitted kitchen, lounge/dining room with access to rear garden, main bedroom with built in wardrobe, good size second bedroom, family bathroom with shower over bath, enclosed rear garden with decked area and shed and parking to the rear.

EPC rating C

Council Tax band C

Available Mid August

Deposit £1500

Viewing

Please contact our Ashford Office on 01233 646411 if you wish to arrange a viewing appointment for this property or require further information.

- MODERN BUILT TERRACED HOME
- POPULAR RESIDENTIAL DEVELOPMENT
- KITCHEN
- LIVING ROOM/DINER
- TWO BEDROOMS
- FIRST FLOOR BATHROOM
- REAR GARDEN WITH DECKING AND SHED
- PARKING
- EPC RATING C. COUNCIL TAX BAND C
- SECURITY DEPOSIT £1500

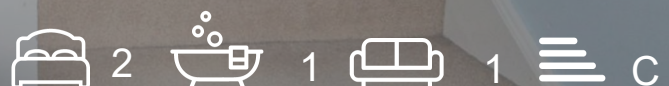

Floor Plan

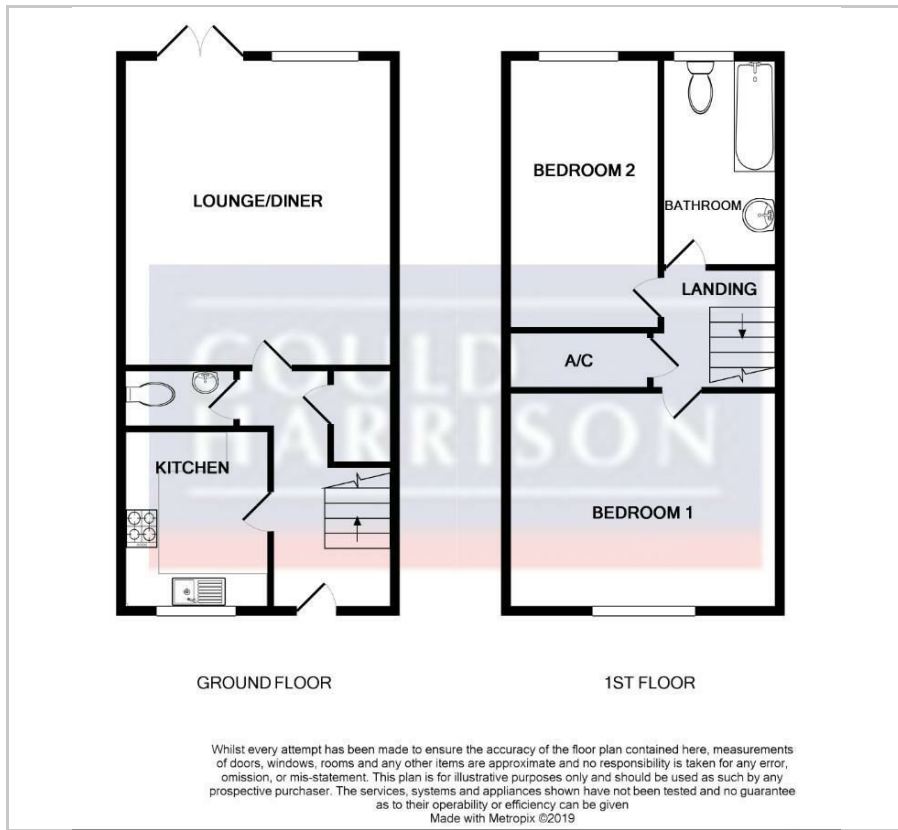

Area Map



Energy Efficiency Graph

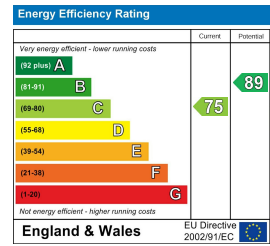

These particulars, whilst believed to be accurate are set out as a general outline only for guidance and do not constitute any part of an offer or contract. Intending purchasers should not rely on them as statements of representation of fact, but must satisfy themselves by inspection or otherwise as to their accuracy. No person in this firm's employment has the authority to make or give any representation or warranty in respect of the property.