

Fahren



## Wootton Mount, Bournemouth

Offers in the Region of £80,000

1 BEDROOM APARTMENT | Well Presented | LOCATED IN THE HEART OF BOURNEMOUTH TOWN CENTRE | SEPARATE KITCHEN | DOUBLE BEDROOM WITH FITTED WARDROBE | 6YEAR LEASE | READY TO VIEW NOW! | NO CHAIN | |



0



Apartment



1



355 sqft (33 sqm)



1



Leasehold





## Wootton Mount, Bournemouth

Offers in the Region of £80,000

Fahren Estate Agents are delighted to present to the market this 1 bedroom first floor apartment in a recently modernised block. This apartment has recently been redecorated and recarpeted.

The accommodation comprises a large, bright lounge with a bay windows and built in storage, a separate kitchen with an array of base and eye level units. There is also space for appliances. There is a good sized double bedroom with fitted wardrobes, and a raised platform for the bed. At the end of the hallway is a bathroom.

The block has gone extensive refurbishment works, and it has delightful communal hallways

Wootton Towers is situated in the heart of Bournemouth Town Centre. It is within easy reach of local shops, restaurants, bus

links, the beach and the train station

This property would make a fantastic buy to let investment, or a great home in a seaside town

Leasehold 99 years from 1995 (68years remaining )

Service charge - £759.60 per half year

Ground rent - £75 per annum

Council Tax Band A

Epc E

Please note the property is currently tenanted .

# Fahren

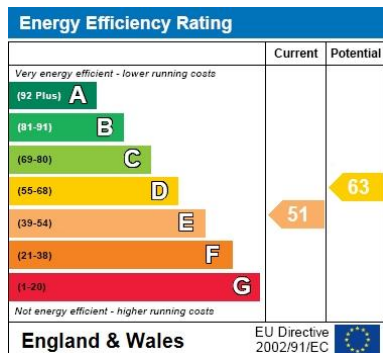

Connect with us



If you would like to book a viewing or find out how much your property is worth please contact us

Tel: 01202 551022

Email: [inf@fahren.co.uk](mailto:inf@fahren.co.uk)

Web: [www.fahren.co.uk](http://www.fahren.co.uk)

GROUND FLOOR  
355 sq.ft. (33.0 sq.m.) approx.

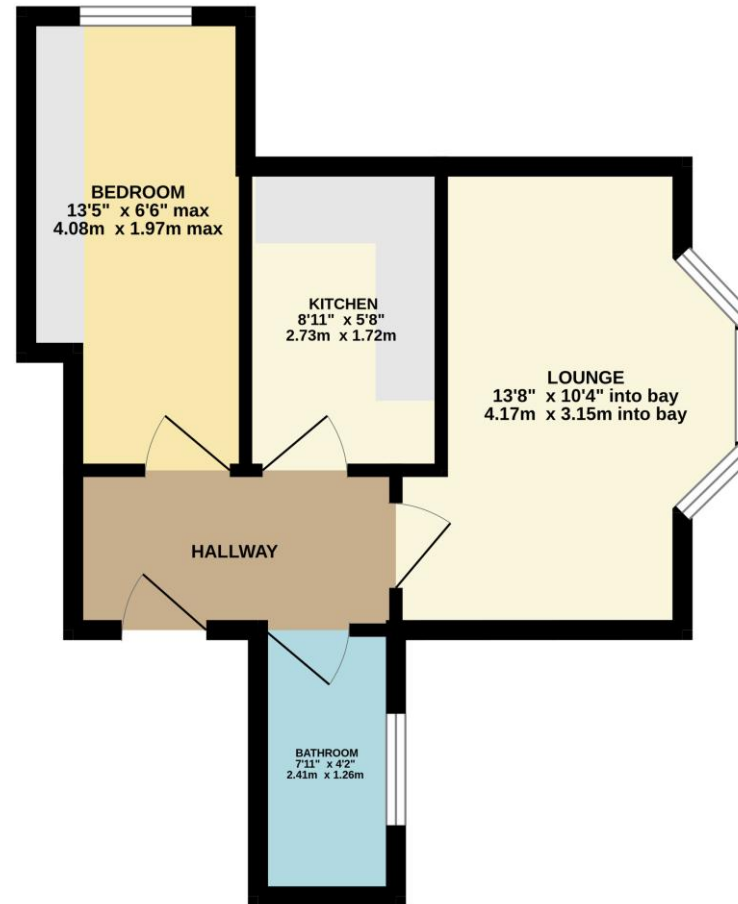

FAHREN ESTATE AGENTS

TOTAL FLOOR AREA: 355 sq.ft. (33.0 sq.m.) approx.

Whilst every attempt has been made to ensure the accuracy of the floorplan contained here, measurements of doors, windows, rooms and any other items are approximate and no responsibility is taken for any error, omission or mis-statement. This plan is for illustrative purposes only and should be used as such by any prospective purchaser. The services, systems and appliances shown have not been tested and no guarantee as to their operability or efficiency can be given.

Made with Metropix ©2023

