



FINCHLEY ROAD, NW3

£375,000

Two Double Bedrooms
Open Plan Kitchen & Reception
Split-Level
Lift Access
Two Balconies
Chain-Free

@marshandparsons
marshandparsons.co.uk

MARSH &
PARSONS



ABOUT THE PROPERTY

Set in a secure purpose built development with lift access is this two double bedroom flat occupying two floors, with the addition of two balconies. The property has an open plan kitchen and reception, built-in storage, a family bathroom and WC, and is available chain-free.

Centre Heights is located on Finchley Road next to the shops, cafe's, and local amenities, and in close proximity to St. Johns Wood and Primrose Hill. Transport links include Swiss Cottage (Jubilee) and South Hampstead (Overground), and multiple bus routes.



STEP INSIDE FINCHLEY ROAD

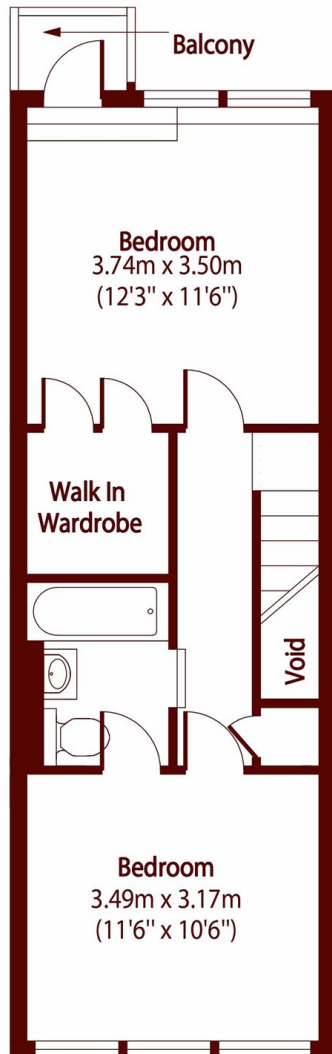

Ninth Floor



Tenth Floor

Total area (approx): 72.18 sq m (777 sq. ft)

Balcony total area (approx): 4.87 sq m (52 sq. ft)

Queen's Park
020 7624 4513

Energy Rating: B We aim to make our particulars both accurate and reliable. However, they are not guaranteed; nor do they form part of an offer or contract. If you require clarification on any points then please contact us, especially if you're traveling some distance to view. Please note that appliances and heating systems have not been tested and therefore no warranties can be given as to their good working order

**MARSH &
PARSONS**