



Ravensbourne Park Crescent, SE6

£290,000

Chain-free two double bedroom purpose-built apartment in a great location close to stations, local amenities, and green spaces. Offering a long lease, allocated garage, and spacious accommodation throughout, the property is in need of modernisation.

Ravensbourne Park Crescent is ideally located close to both Catford Station and Catford Bridge Station, offering excellent connections into Central London and beyond. The area is well placed for access to popular green spaces including Ladywell Fields. Residents also benefit from a wide range of local shops, cafés, supermarkets, and everyday amenities nearby in Catford town centre.

Features

- Purpose Built Block
- Two Double Bedrooms
- In Need Of Modernisation
- Long Lease
- Allocated Garage
- Chain Free

Ravensbourne Park Crescent, London, SE6

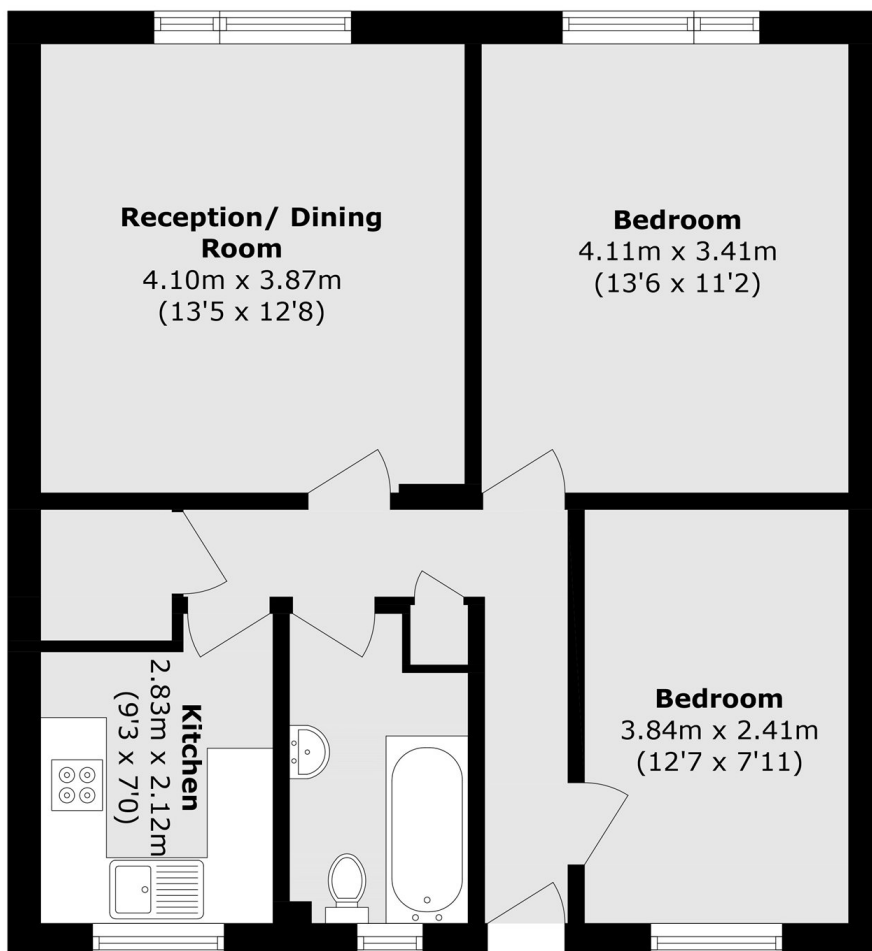

Total area (approx.): 59.2 sq. m (637.2 sq. ft)