



TO LET



20 Twerton Farm Close, Bath, BA2 1BL

£995 Per Month



- First Floor Apartment
- Open Planned Kitchen Living Room
- Allocated Parking Space
- One Bedroom
- Bathroom
- Council Tax Band A - £1,550.18

THE PROPERTY

A well presented one-bedroom first-floor apartment available to rent in the peaceful cul-de-sac of Twerton Farm Close, Bath. Boasting a bright open-plan layout, allocated off-street parking, a premier commuter location just 0.7 miles from Oldfield Park railway station, and immediate access to the local amenities of Twerton High Street, this property represents the perfect home for single professionals or couples looking for convenience and connectivity. Available Now.

Approx Gross Internal Area
44 sq m / 469 sq ft

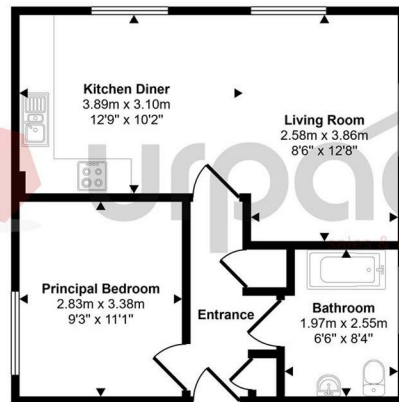

Floorplan

This floorplan is only for illustrative purposes and is not to scale. Measurements of rooms, doors, windows, and any items are approximate and no responsibility is taken for any error, omission or mis-statement. Icons of items such as bathroom suites are representations only and may not look like the real items. Made with Made Snappy 360.

SITUATION

Directions