



Charter Drive, Bexley, Greater London, DA5



Harpers & Co



CHARTER DRIVE

BEXLEY DA5

- 3 BEDROOMS
- UPVC DOUBLE GLAZED WINDOWS AND DOORS
- QUIET CUL DE SAC
- DRIVEWAY
- SPACIOUS LIVING
- DOWNSTAIRS BATHROOM
- LOCAL AMENITIES NEARBY
- LOCAL TRANSPORT LINKS

Charter Drive, Bexley

Property Summary

3 BEDROOM SEMI DETACHED BUNGALOW 2 BATHS SUPERB GARDEN CLOESE TO BEXLEY VILLAGE

This attractive three-bedroom semi-detached split-level bungalow is a credit to its current owner. Located on Charter Drive offers spacious and versatile accommodation, ideal for families and downsizers alike. The property features a large, bright living room finished to a modern standard, creating a comfortable and stylish space for relaxing and entertaining. The kitchen provides practical workspace and storage, while the separate dining room offers a dedicated area for family meals and social gatherings, complemented by tasteful décor. The ground floor also benefits from a well-proportioned double bedroom and a family bathroom, providing convenient and flexible living arrangements. Upstairs, the impressive master bedroom benefits from a unique open-plan layout incorporating a freestanding shower. This room offers great space and is versatile. A further single bedroom provides versatile accommodation, perfect for guests, a child's room, or a home office. Externally, the property boasts a mature and beautiful rear garden laid mainly to lawn, offering excellent outdoor space for families, gardening enthusiasts, or those who enjoy outdoor entertaining with a purpose built BBQ area. Combining generous living space, modern features, and a large rear garden, this charming bungalow presents an excellent opportunity in a desirable and sought-after location. Viewings by appointment only through award winning Harpers & Co.



Accommodation

Entrance Hallway

Entrance hallway, modern décor, skirting, coving, radiator carpeted throughout, multiple plug points, dado rail.

Reception Room 16' 5" x 10' 6" (5.00m x 3.21m)

Carpeted throughout, skirting, coving, multiple plug points, neutral décor, dado rail, UPVC double glazed bay window to front, radiator, feature fireplace, pendant light to ceiling.

Kitchen 10' 6" x 10' 0" (3.20m x 3.05m)

Tiled floor and splashbacks, range of wall and base units, UPVC double glazed window and rear door to garden, breakfast bar, electric hob, mixer tap with double sink, built in electric oven and grill, spotlights, wooden beamed ceiling, multiple plug points, radiator, plumbed for washing machine and space for fridge freezer.

Dining Room 14' 0" x 11' 0" (4.26m x 3.35m)

Carpeted throughout, UPVC doors and windows leading to garden, chandelier lighting lighting, skirting, coving, fireplace (untested), Multiple plug points, radiators

Family Bathroom 7' 1" x 6' 7" (2.15m x 2.00m)

Bath with shower attachment, sink, and toilet, Single UPVC double glazed window,, tiled.

Bedroom 11' 0" x 9' 1" (3.35m x 2.76m)

Carpeted throughout, multiple plug points, pendent lighting, skirting, coving, storge cupboard, radiator, UPVC double glazed window to front.

Master bedroom 20' 0" x 10' 6" (6.10m x 3.20m)

Carpeted throughout, multiple plug points, radiators, freestanding shower, built in storage space under eaves, chandelier lighting, windows to front and back, skirting, picture rail

Bedroom 11' 0" x 9' 2" (3.35m x 2.80m)

UPVC window, radiator, eaves with storage, skirting, multiple plug points, carpeted throughout

Rear Garden

Patio, grass laid to lawn, pathway to rear of garden, storage shed, trees, shrubs, pergola, decked bridge



Harpers & Co



Harpers & Co



Harpers & Co



This excellent bungalow is a gem! Presented well and offering good useable space, it will make an excellent family home proving good size functional reception rooms, kitchen and bedrooms. The garden is a credit to the current owner as it is immaculate, mature and well established.

Viewings through sole agents Harpers & Co on 01322 524425 or info@harpersandco.com



Ground Floor

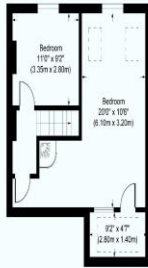

First Floor



Charter Drive

Approximate Gross Internal Area
 Ground Floor = 65.1 sq m / 702 sq ft
 First Floor = 40.8 sq m / 440 sq ft
 Total = 105.9 sq m / 1142 sq ft

This plan is for layout guidance only. Not drawn to scale unless stated. Windows and door openings are approximate. Whilst every care is taken in the preparation of this plan, please check all dimensions, shapes and compass bearings before making any decisions reliant upon them.



Energy Efficiency Rating		Current	Potential
Very energy efficient - lower running costs			
(92+)	A		
(81-91)	B		
(69-80)	C		
(55-68)	D	61	75
(39-54)	E		
(21-38)	F		
(1-20)	G		
Not energy efficient - higher running costs			
England & Wales		EU Directive 2002/91/EC	
		www.epc4u.com	

Bexley / Bexleyheath Department
 8 Bexley High Street
 Bexley
 DA5 1AD
 T: 01322 524425
 E: info@harpersandco.com

Associate Park Lane
 121 Park Lane
 Mayfair
 W1K 7AG
 T: 0207 409 4693
 E: info@harpersandco.com

harpersandco.com



The Agent has not tested any apparatus, equipment, fixtures and fittings or services and so cannot verify that they are in working order or fit for the purpose. A Buyer is advised to obtain verification from their Solicitor or Surveyor. References to the Tenure of a Property are based on information supplied by the Seller. The Agent has not had sight of the title documents. A Buyer is advised to obtain verification from their Solicitor. We have taken every precaution to ensure that these details are accurate and not misleading. If there is any point which is of particular importance to you, please contact us and we will provide any information you require. The mention of any appliances and services within these details does not imply that they are in full and efficient working order or that they will remain within the property.