

# GUILDHALL

SALES & LETTINGS



GUILDHALL  
SALES & LETTINGS

## 23 Rosebay Gardens

Higher Walton, Preston, PR5 4BS

Offers Over £425,000



Stunning Four-Bedroom Detached Home in Higher Walton

A beautifully presented, modern four-bedroom detached family home, situated on the sought-after Rosebay Gardens in Higher Walton. This turn-key ready property has been decorated to a high standard throughout, offering a stylish and contemporary living space.

The ground floor features a spacious open-plan kitchen diner, perfect for entertaining, with plenty of natural light and modern fittings. The integral garage provides added convenience, while driveway parking ensures ample space for multiple vehicles.

Upstairs, the principal bedrooms (1 & 2) benefit from luxurious en-suite facilities, offering comfort and privacy. Bedrooms 3 and 4 are generously sized, ideal for family, guests, or a home office.



Ground Floor

- Entrance Hall 14'22 x 6'97 (4.27m x 1.83m)
- WC 6'88 x 3'21 (1.83m x 0.91m)
- Lounge 15'31 x 10'73 (4.57m x 3.05m)
- Kitchen/Diner 21'87 x 11'31 (6.40m x 3.35m)
- Utility 9'43 x 5'33 (2.74m x 1.52m)

First Floor

- Landing 12'32 x 10'61 (3.66m x 3.05m)
- Bedroom One 14'39 x 13'09 (4.27m x 4.19m)
- En-suite 7'99 x 4'50 (2.13m x 1.22m)
- Bedroom Two 12'03 x 11'32 (3.73m x 3.35m)
- En-suite 5'81 x 5'17 (1.52m x 1.52m)
- Bedroom Three 11'75 x 9'21 (3.35m x 2.74m)
- Bedroom Four 11'15 x 9'41 (3.35m x 2.74m)

External

- Garage 17'90 x 8'34 (5.18m x 2.44m)
- Bar 27'17 x 12'43 (8.23m x 3.66m)

Area Map



Floor Plans

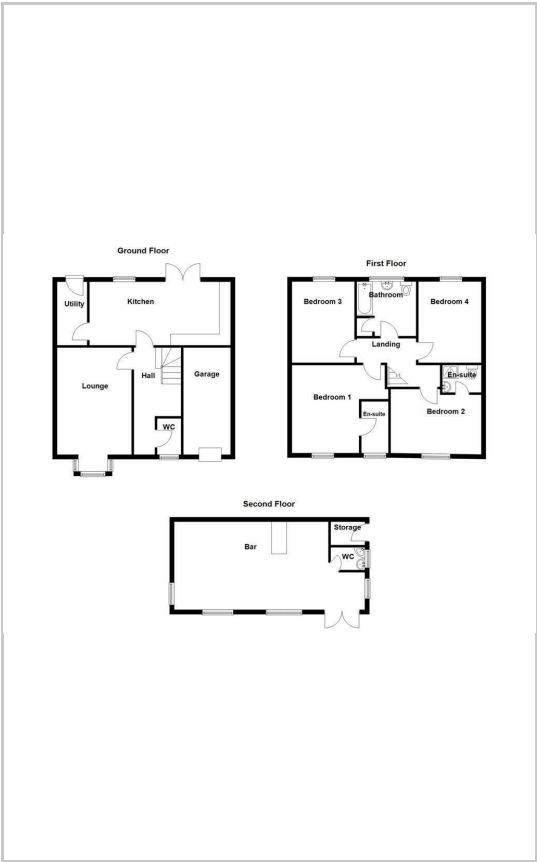

Energy Efficiency Graph

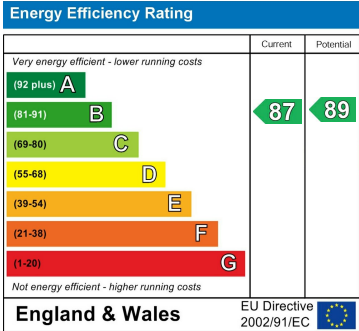

These particulars, whilst believed to be accurate are set out as a general outline only for guidance and do not constitute any part of an offer or contract. Intending purchasers should not rely on them as statements of representation of fact, but must satisfy themselves by inspection or otherwise as to their accuracy. No person in this firms employment has the authority to make or give any representation or warranty in respect of the property.