

White Horse View, York YO61 4AG

£195,000

Stephensons
estate agents & chartered surveyors



A rare and exciting renovation opportunity to update and improve a 2 bedroom cottage in the picturesque village of Kilburn, just under 6 miles south east of Thirsk, 7.5 miles north of Easingwold and 20 miles from York. The cottage provides generous off road parking and features a 45 metre long rear garden with stunning views of the White Horse.

Tenure: Freehold
 Services/Utilities: Electricity, Water and Sewerage are understood to be connected
 Broadband: Up to 76 Mbps* download speed
 EPC Rating: G - 1
 Council Tax: C - North Yorkshire Council
 Current Planning Permission: No current valid planning permissions

*Download speeds vary by broadband providers so please check with them before purchasing.



A side porch leads off into a sitting room with exposed beams and open fireplace and a dining kitchen with further beams, open fireplace, walk-in pantry and an opportunity to update, replace and restyle the existing 1970's base units.

The side porch also provides access out into the rear garden, a door leading off into a fuel store and a bathroom presenting a further opportunity for a buyer to update, replace and restyle to their own taste.

The first floor landing leads off into 2 double bedrooms, both with en-suite wash rooms featuring a basin and wc.

A driveway at the front of the property provides generous parking and a part paved courtyard area off the side porch at the rear of the cottage allows access into an attached stone built barn and steps leading up to the 45m long rear garden which climbs up to reveal breathtaking views toward the White Horse.

AGENTS NOTE

Imagery Disclaimer: Some photographs and videos within these sales particulars may have been digitally enhanced or edited for marketing purposes. They are intended to provide a general representation of the property and should not be relied upon as an exact depiction.

DON'T MISS OUT ON YOUR NEXT HOME

Last year, our social media content reached over 6.7 million views. By following Stephensons, you'll get exclusive video content, pre-market property teasers, off-market opportunities and early access to new listings before they appear online. Follow us today and stay one step ahead of other house hunters. Simply search @stephensons1871 on your favourite social media platform and start exploring.

White Horse View , Kilburn , York, YO61 4AG

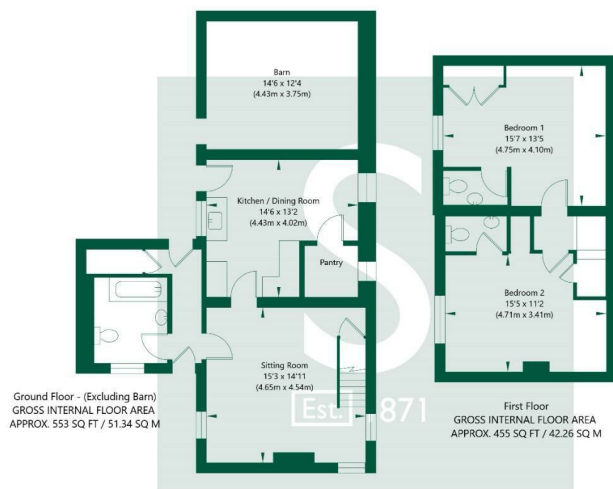

NOT TO SCALE - FOR ILLUSTRATIVE PURPOSES ONLY
 APPROXIMATE GROSS INTERNAL FLOOR AREA 1008 SQ FT / 93.6 SQ M - (Excluding Barn)
 All measurements and fixtures including doors and windows are approximate and should be independently verified.
 www.exposurepropertymarketing.com © 2025

Partners:

- J F Stephenson MA (Cantab) FRICS FAAV
- I E Reynolds BSc (Est Man) FRICS
- R E F Stephenson BSc (Est Man) MRICS FAAV
- N J C Kay BA (Hons) pg. dip MRICS
- O J Newby FNAEA
- J E Reynolds BA (Hons) MRICS
- R L Cordingley BSc FRICS FAAV
- J C Drewniak BA (Hons)
- E G Newby MRICS
- T Brooks MNAEA

York: 01904 625533
 Boroughbridge: 01423 324324
 Easingwold: 01347 821145

Associate Partners:

- N Lawrence
- I Jarvis MNAEA

Selby: 01757 706707
 Haxby: 01904 809900